



Oversight and Governance

Chief Executive's Department

Plymouth City Council

Ballard House

Plymouth PL1 3BJ

T 01752 305155

www.plymouth.gov.uk/democracy

Published 23/09/20

Delegated Decisions

Delegated Executive/Officer Decisions

Delegated Executive and Officer decisions are published every Wednesday and are available at the following link - <https://tinyurl.com/ms6umor>

Cabinet decisions subject to call-in are published at the following link - <http://tinyurl.com/yddrqll6>

Notice of call-in for non-urgent decisions must be given to the Democratic Support Unit by 4.30pm on Wednesday 30 September 2020. Please note – urgent decisions and non-key Council Officer decisions cannot be called in. Copies of the decisions together with background reports are available for viewing as follows:

- on the Council's Intranet Site at <https://modgov/mgDelegatedDecisions.aspx>
- on the Council's website at <https://tinyurl.com/jhnax4e>

The decisions detailed below may be implemented on Thursday 1 October 2020 if they are not called-in.

Delegated Decisions

1. Councillor Haydon - Cabinet Member for Customer Focus and Community Safety:

- Ia. City Wide Public Spaces Protection Order 2020 **(Pages 1 - 26)**
- Ib. Public Spaces Protection Order Control of Dogs 2020 **(Pages 27 - 76)**

2. Councillor Coker - Cabinet Member for Strategic Planning and Infrastructure:

- 2a. The City of Plymouth (TRO) (Amendment Order No.2020.2137238 Taxi Scheme) Order * The City of Plymouth (TRO) (Taxi Ranks) (Amendment Order No.2020.2137238 Taxi Scheme) Order (Cornwall Street, Eastlake Street, St Andrews Cross & Whimble Street) **(Pages 77 - 94)**

EXECUTIVE DECISION

made by a Cabinet Member



REPORT OF ACTION TAKEN UNDER DELEGATED AUTHORITY BY AN INDIVIDUAL CABINET MEMBER

Executive Decision Reference Number – CFCS03 20/21

Decision	
1	Title of decision: City Wide Public Spaces Protection Order 2020
2	Decision maker (Cabinet member name and portfolio title): Councillor Haydon. Cabinet member for Customer Focus and Community Safety.
3	Report author and contact details: Community Connections Strategic Manager Dave Ryland, dave.ryland@plymouth.gov.uk 01752 304823
4	Decision to be taken: <ol style="list-style-type: none"> 1. Agree new City Wide Public Spaces Protection Order 2020. 2. Agree the discharge of the existing Public Spaces Protection Orders covering City Centre & Stonehouse, Stonehouse, Devonport, North Hill, Mutley, Freedom Fields and Tothill Park
5	Reasons for decision: <p>Under the Anti-Social Crime and Policing Act 2014 local authorities have listed provisions to address matters of Anti-Social Behaviour.</p> <p>Working with partners across the city, Plymouth City Council has identified that existing provisions to address anti-social behaviour linked to the consumption of alcohol are ineffective in their current form. To equip resources with the appropriate tools to address matters the existing Public Space Protection Orders are required to be revoked and a new Public Space Protection Order implemented across the city to address both existing and arising issues.</p> <p>The implementation of a city wide Public Space Protection Order would enable a speedy and effective response to a specific type of Anti-Social Behaviour and offers heightened reassurance to residents across the city. In turn it is hoped that this will improve confidence in services and increase feelings of safety in the community. The order would impose the following prohibitions and/or requirements at all times within the boundary of the city:</p> <ol style="list-style-type: none"> 1. No person shall continue to consume alcohol, or anything which is reasonably believed to be alcohol, when asked to stop by an authorised person 2. No person shall fail to surrender a vessel(s) of alcohol, sealed or unsealed when requested by an authorised officer who, in their view believe this would assist in preventing further anti-social behaviour, public nuisance or disorder <p>An “authorised officer” means an employee of the council, Police Community Support Officer or other person who is authorised in writing by the council.</p> <p>A citywide order linked to the displayed behaviours opposed to direct consumption of alcohol would</p>

	<p>mean that the use of the order will only effect those who are displaying behaviours causing harassment, alarm or distress. As such this order would not impact the majority of residents or visitors to the city. Furthermore utilising the power in this manner opposed to an outright banning of public alcohol consumption, would limit the possibility of an authorised person inadvertently causing an individual to suffer an alcohol withdrawal related medical episode.</p> <p>It is hoped a citywide PSPO could reduce the “need” to gather in large groups in very small geographies as it will be apparent to the community in question that their treatment will not differ from area to area within the city boundary.</p> <p>A citywide PSPO will give authorised officers the tools necessary to effectively prevent the escalation of anti-social behaviour as and when it occurs. This immediate solution can alleviate problems in the first instance. It will also highlight pockets of this behaviour which would allow Plymouth City Council to work with partners to focus our longer term interventions and support in the areas where the PSPO prohibition is being enforced most frequently.</p> <p>Public consultation has shown support for a citywide approach to be adopted with 85.7% of returns in agreement.</p> <p>Enforcement will be in line with the anti-social behaviour escalation process as this has been agreed as the most suitable enforcement approach and tested in the Stonehouse Pilot PSPO. The process is designed to sit alongside the city and organisational vision of employing a Trauma Informed Approach. This escalation process offers relevant signposting, support and interventions alongside enforcement.</p> <p>The implementation of this order will in turn result in the existing Public Space Protection Orders covering, City Centre and Stonehouse, Stonehouse, Devonport, North Hill, Mutley, Freedom Fields and Tothill Park, being discharged.</p>			
6	<p>Alternative options considered and rejected:</p> <p>Continue with existing approach. This approach is currently not addressing the issues being reported outside of existing Public Space Protection Order boundaries and is not equipping resources with the tools to address either emerging or existing issues.</p> <p>Enhance existing approach by developing prohibitions whilst maintaining the micro boundaries of live Public Space Protection Order's. This approach could lead to confusion in both persons effected and authorised to enforce. This approach would be ineffective in dealing with emerging trends if they are outside of a defined geography.</p> <p>Citywide Public Space Protection Order with prohibitions 1 and 2, listed in section 5, with fixed penalty notices issued. The majority of persons who are likely to be subject of breaching the order are not deemed to have the financial resource to pay for fines. Furthermore in developing a trauma informed approach with support options available to offenders, this approach would impact effectiveness and result in disengagement, preventing causal issues being addressed.</p>			
7	<p>Financial implications: The minimal cost for the removal of old signage, printing of and installation of new signs will be met from the existing Community Connections budget; the technical accounting officer responsible for the service area has been informed</p>			
8	<p>Is the decision a Key Decision? (please contact Democratic Support for further advice)</p>	<p>Yes</p>	<p>No</p>	<p>Per the Constitution, a key decision is one which:</p>
			X	<p>in the case of capital projects and contract awards, results in a new commitment to spend and/or save in excess of £3million in total</p>

			X	in the case of revenue projects when the decision involves entering into new commitments and/or making new savings in excess of £1 million
			X	is significant in terms of its effect on communities living or working in an area comprising two or more wards in the area of the local authority.
	If yes, date of publication of the notice in the Forward Plan of Key Decisions			
9	Please specify how this decision is linked to the Council's corporate plan/Plymouth Plan and/or the policy framework and/or the revenue/capital budget:		The implementation of this order is aligned to the corporate plan showing that we are taking responsibility and being fair in our approach. It displays that we are caring in helping people feel safe in Plymouth and providing a welcoming city.	
10	Please specify any direct environmental implications of the decision (carbon impact)		N/A	
Urgent decisions				
11	Is the decision urgent and to be implemented immediately in the interests of the Council or the public?	Yes		(If yes, please contact Democratic Support (democraticsupport@plymouth.gov.uk) for advice)
		No		(If no, go to section 13a)
12a	Reason for urgency:			
12b	Scrutiny Chair Signature:		Date	
	Scrutiny Committee name:			
	Print Name:			
Consultation				
13a	Are any other Cabinet members' portfolios affected by the decision?	Yes		
		No	X	(If no go to section 14)
13b	Which other Cabinet member's portfolio is affected by the decision?			
13c	Date Cabinet member consulted			

14	Has any Cabinet member declared a conflict of interest in relation to the decision?	Yes		If yes, please discuss with the Monitoring Officer				
		No						
15	Which Corporate Management Team member has been consulted?	Name	Craig McArdle					
		Job title	Strategic Director for People					
		Date consulted	15 September 2020					
Sign-off								
16	Sign off codes from the relevant departments consulted:	Democratic Support (mandatory)	DS33 20/21					
		Finance (mandatory)	djn.20.21.91					
		Legal (mandatory)	33570/ag/17.9.2020					
		Human Resources (if applicable)						
		Corporate property (if applicable)						
		Procurement (if applicable)						
Appendices								
17	Ref.	Title of appendix						
	A	Briefing report for publication (<i>mandatory</i>)						
	B	Equalities Impact Assessment (<i>where required</i>)						
Confidential/exempt information								
18a	Do you need to include any confidential/exempt information?	Yes		If yes, prepare a second, confidential ('Part II') briefing report and indicate why it is not for publication by virtue of Part I of Schedule 12A of the Local Government Act 1972 by ticking the relevant box in 18b below. (Keep as much information as possible in the briefing report that will be in the public domain)				
		No	X					
		Exemption Paragraph Number						
		1	2	3	4	5	6	7
18b	Confidential/exempt briefing report title:							

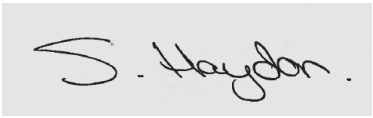
Background Papers								
19	<p>Please list all unpublished, background papers relevant to the decision in the table below.</p> <p>Background papers are <u>unpublished</u> works, relied on to a material extent in preparing the report, which disclose facts or matters on which the report or an important part of the work is based. If some/all of the information is confidential, you must indicate why it is not for publication by virtue of Part 1 of Schedule 12A of the Local Government Act 1972 by ticking the relevant box.</p>							
Title of background paper(s)		Exemption Paragraph Number						
		1	2	3	4	5	6	7
Police application for PSPO								
Cabinet Member Signature								
20	<p>I agree the decision and confirm that it is not contrary to the Council's policy and budget framework, Corporate Plan or Budget. In taking this decision I have given due regard to the Council's duty to promote equality of opportunity, eliminate unlawful discrimination and promote good relations between people who share protected characteristics under the Equalities Act and those who do not. For further details please see the EIA attached.</p>							
Signature				Date of decision		21/09/2020		
Print Name		Cllr SALLY HAYDON						

This page is intentionally left blank

CREATING A NEW PUBLIC SPACES PROTECTION ORDER – CITYWIDE ALCOHOL CONTROL

Community Connections



1.0 Executive Summary

Public Space Protection Orders (PSPO's) are required to be reviewed every 3 years in order to renew or vary it. In Plymouth currently the 6 PSPO's which had transferred from being Designated Public Place Orders expire on the 19th October 2020. In addition the review of the Stonehouse PSPO has been completed.

A consultation process has been undertaken to explore the support for implementing a citywide order to prevent further anti-social behaviour linked to the consumption of alcohol. The consultation reached over 27,000 people via both Twitter and Facebook.

83.7% of responders were in agreement that a citywide PSPO would be of benefit to the city.

85.7% of responders believed that a citywide order would offer consistency and fairness

The Council propose to discharge the 6 existing PSPO's previously DPPO's and the Stonehouse PSPO and implement one PSPO across the city. It is intended that a new Public Spaces Protection Order will come into effect on the 20th October.

2.0 Background to Public Spaces Protection Orders

Public Spaces Protection Orders (PSPOs) were introduced in the Anti-social Behaviour, Crime and Policing Act 2014. The primary purpose of the PSPO is to empower local authorities to deal with anti-social behaviour that adversely affects other people using the same public space.

A PSPO may only prohibit or impose requirements that are reasonable to prevent or reduce the detrimental effect from continuing, occurring or recurring. A local authority may make a PSPO if they are satisfied that the following 2 conditions are met:

1. Activities carried out in a public place within the authority's area are having or have had a detrimental effect on the quality of life of those in the locality, or it is likely that the activities will be carried out in a public place within that area and they will have such an effect
2. The effect or likely effect of the activity:
 - Is or is likely to be of a persistent or continuing nature
 - Is or is likely to be such as to make the activities unreasonable, and
 - Justifies the restrictions imposed by the notice

Local authorities should consider that the requirements and prohibitions are reasonable. When drafting an Order placing restrictions on any activity, Councils should propose restrictions which focus on specific behaviours and be proportionate to the detrimental effect that the behaviour is causing or can cause, and are necessary to prevent it from continuing, occurring or reoccurring.

A person will commit an offence if they do something that is prohibited or fails to comply with a PSPO.

A PSPO can be put in place for up to 3 years. Then the PSPO must be reviewed to ensure it is still necessary. Before extending or varying the PSPO, local authorities must consult with the local chief of police, the police and crime commissioner, owners or occupiers of land within any affected area and appropriate community representatives. The new PSPO will remain in force for a further 3 years.

In accordance with the Anti-social Behaviour, Crime and Policing Act 2014 (Publication of Public Spaces Protection Orders) Regulations 2014, the local authority must publish the order as made, extended or varied on its website and erect appropriate notices on or adjacent to the public place to which the order relates.

3.0 Current Public Spaces Protection Order

The 6 existing PSPO's which transferred from DPPO's in October 2017 due to the change of legislation cover Plymouth City Centre, Devonport, North Hill, Mutley Plain, Tothill Park and Freedom Fields. Some of the DPPO's were put in place in 2009 and have at no point been subject to review. When the orders transferred to PSPO's the wording was no longer current or relevant due to the change in legislation. This has been addressed via PCC website. However this should be considered as a temporary measure.

The current PSPO covering Stonehouse was implemented in November 2017 and contains the following prohibitions;

- No person shall ingest, inject or inhale non-prescribed intoxicants in a public place
- No person shall fail to surrender an open vessel(s) of alcohol in a public place when requested to by an authorised officer
- No person shall beg or ask members of the public for money.
- No person shall urinate or defecate in a public place.
- No person shall use a vehicle in an antisocial manner.

The land to which these restrictions apply are detailed in the Order. The published Orders can be found on the Council's website:

<https://www.plymouth.gov.uk/crimepreventionandantisocialbehaviour/saferplymouth>

4.0 Internal consultation of the relevant city PSPO's

Meetings were held with a number of relevant internal departments and Portfolio Holders.

It was concluded that there was benefit to wider use of PSPO's across the city and that this should be focused on alcohol control measures.

It was considered that the Council should consult on the implementation of a citywide order to reduce anti-social behaviour linked to the consumption of alcohol. It should however be made clear that this is not represent a ban on public consumption of alcohol but consumption linked to anti-social behaviour.

Proposed wording for the prohibition for the citywide order consultation was:

- a) it shall be an offence for any person to refuse to stop drinking alcohol or hand over any containers (sealed or unsealed) which are believed to contain alcohol, when required to do so

by a police officer or authorised officer who, in their view believes this would assist in preventing further anti-social behaviour, public nuisance or disorder unless:

- b) he/she has an reasonable excuse for failing to do so

The final wording of this prohibition in the citywide order differs slightly to emphasise the requirement for a person to stop consuming alcohol (or anything believed to be alcohol) and to surrender it to prevent further anti-social behaviour.

5.0 Reasons for the proposed changes to the PSPO's

1. A singular citywide order prohibiting alcohol consumption linked to anti-social behaviour would provide a consistent, fair and equitable approach in tackling anti-social behaviour linked to alcohol consumption across the city. It would also leave no room for confusion.
2. The seven current PSPO's in different localities can be confusing to residents and officers' alike,
3. Due to numerous boundaries and differing wording, these orders are enforced very differently depending on the local policing team, public perception and resource availability.
4. A citywide order would enable a speedy and effective response to this specific type of ASB. This offers heightened reassurance to residents across the city, in turn this will improve confidence in services, and increase feelings of safety in the community.
5. A citywide order linked to the displayed behaviours as opposed to the consumption of alcohol would limit the possibility of an authorised person inadvertently causing an individual to suffer an alcohol withdrawal related medical episode.
6. A citywide PSPO would offer alcohol dependent individuals a consistent approach. This in turn could improve relationships between this community and professionals which may lead to better engagement with support.
7. A citywide PSPO could reduce the "need" to gather in large groups in very small geographies as it will be apparent to the community in question that their treatment will not differ from area to area within the city.

A citywide PSPO will give authorised officers the tools necessary to effectively prevent the escalation of anti-social behaviour as and when it occurs. This immediate solution can alleviate problems in the first instance. It will also highlight pockets of this behaviour which would allow us to work with partners to focus our longer term interventions and support in the areas where the PSPO prohibition is being enforced most frequently.

Prohibitions not directly linked towards the consumption of alcohol have not been utilised. Keeping unutilised prohibitions in place offers little relief to communities and makes work for relevant parties harder in managing expectations.

6.0 External consultation for implementing a Citywide PSPO

The external consultation has been carried out in accordance with the LGA Public Spaces Protection Order Guidance for councils. Any proposed extension or variation of the existing PSPO requires consultation with statutory consultees and the public.

The details of the consultation were put on the Council's website, social media Facebook and Twitter accounts and in the Herald.

Consultation details were sent to the Devon and Cornwall Police and Crime Commissioner, the Chief Officer of Police, the LPA Police inspectors for the city.

Details were sent to relevant partners working with those commonly found to be suffering adverse effects from alcohol addiction.

Details were sent to all Members and relevant internal departments, including Public Protection, Street Services, Public Health, Licensing and the Legal Department.

7.0 Results of Consultation

Reach;

PCC Twitter 2,325

PCC Facebook undefined but believed to be greater than Twitter.

Plymouth Live 25,152 Facebook

The consultation results are as follows;

Q1 To what extent do you agree or disagree that alcohol related anti-social behaviour could affect any neighbourhood across the city?

Agree 96% Disagree 4%

Q2 To what extent do you agree or disagree that the city will benefit from the introduction of a city wide PSPO?

Agree 83.7% Disagree 10.2% Neither Agree or Disagree 6.1%

Q3 To what extent do you agree or disagree that implementing an order across the entire city brings consistency and fairness?

Agree 85.7% Disagree 8.2% Neither Agree or Disagree 6.1%

8.0 Recommendations

The Council have undertaken the required consultation process to implement a new Citywide PSPO focused on anti-social consumption of alcohol.

The views of the responders have been taken into account and are reflected in the new draft PSPO.

It is recommended that the proposals which have been supported are included in the new City Wide Public Spaces Protection Order 2020.

The new Order will be published on the Council's website. Signage will be installed in appropriate places to highlight the new restrictions.

EQUALITY IMPACT ASSESSMENT

Community Connections – City Wide Public Space Protection Order



STAGE 1: WHAT IS BEING ASSESSED AND BY WHOM?

What is being assessed - including a brief description of aims and objectives?

Public Spaces Protection Order.

The Public Spaces Protection Order (PSPO) is one of the powers available to Local Authorities under the Anti-Social behaviour, Crime and Policing Act 2014. This legislation enables the Local Authority to introduce a PSPO to an area to deal with a particular nuisance which is detrimental to the local community’s life. It is designed to ensure the majority can use and enjoy public spaces safe from crime and antisocial behaviour (ASB). The aim of the PSPO is to reduce anti-social and nuisance behaviour that can be attributed to the consumption of alcohol in public spaces .This is an issue that is known to have a detrimental effect in communities and can impact both quality of home life and business. The PSPO does not place a ban on public alcohol consumption; rather it allows for greater control of alcohol consumption where it becomes of a problematic nature – e.g. large groups of consuming alcohol intimidating residents/passers-by; and gives police additional powers within a designated area to tackle alcohol consumption in public spaces where those anti-social behaviours are attributed to alcohol consumption.

Plymouth has adopted a Trauma Informed, person centred approach to business. This approach seeks to tackle root cause issues and not use a quick fix style in tackling complex issues. With this in mind the use of this particular legislation seeks to support those who are alcohol dependent whilst offering solutions to the communities impacted. This vulnerable community often frequent public spaces to consume alcohol. This prohibition will focus on reducing the disruption and nuisance caused by the minority. It will focus on behaviours such as rowdy behaviour, use of foul language and will only be used to tackle the behaviours, not the act of consuming alcohol in public. This will reduce the likelihood of those who are addicted to alcohol being penalised simply due to circumstances. It is understood that a number of those individuals drinking alcohol in public places are doing so not only to manage their addiction to alcohol but also as their place of residence does not allow for the consumption of alcohol.

Potential displacement issues following the introduction of the PSPO will be closely monitored. However it is believed that this approach has the potential to reduce current localised displacements as the order is citywide. If those who are most vulnerable are feeling less need to be transient this could lead to an improved continuity of support offer. This would maximise opportunities for those most who are vulnerable to link in meaningfully with those services that are in place to assist. Recognising both the complexity of these individuals and the financial limitation that they face Plymouth City Council has agreed the use of a bespoke Anti-Social Behaviour escalation process to deal with persistent breaches of a PSPO. At all times suitable support and interventions will be offered to those who have issues linked to the misuse of alcohol and this PSPO application is designed to offer this relevant support at every opportunity.

Plymouth City Council will continue to work with all relevant support agencies, alongside Devon and Cornwall Police throughout the duration of the PSPO to ensure that as and when individual needs are identified, suitable support is found and offered. This approach will balance the needs of vulnerable individuals with the needs and rights of wider communities to live in a city free from Anti-Social Behaviour. It is anticipated that all residents of Plymouth will benefit from the introduction of this PSPO. All cases will be dealt with on an individual basis and the PSPO will always consider the test of “reasonable excuse”, providing and exemption from the order if the excuse for the behaviour is reasonable.

Current data shows;

8,838 Anti-Social Behaviour incidents recorded, of which 10% are related to Street Drinking (861). Reported incidence of Street Drinking has decreased by 7% compared with previous years.

- 13% of all recorded crime is flagged as Alcohol-related. Alcohol related crime has risen by 12% over the last 12 months (2795 to 3143 – 348 increase).
- Plymouth is estimated to have 1.58% dependent drinkers (3,320) compared to 1.26% across the South West region and 1.39% nationally.
- Rates of alcohol-related admissions are lower than the national average (546 hospital admissions per 1000,000 population compared to 570 nationally).
- Problem Drinking and Alcohol Related Hospital admissions has been highlighted as a high risk and should be prioritised by Safer Plymouth and all of its partners.
- Alcohol Related Crime has been identified as a moderate risk.

Author	Dave Ryland
Department and service	People, Community Connections
Date of assessment	17/02/20

STAGE 2: EVIDENCE AND IMPACT

Protected characteristics (Equality Act)	Evidence and information (eg data and feedback)	Any adverse impact See guidance on how to make judgement	Actions	Timescale and who is responsible
Age	<p>The introduction of this PSPO will not target a specific age range. Plymouth does not hold any precise data as to the average age of those who are alcohol addicted “street drinkers”.</p> <p>For the purpose of this EI the term “street drinker” refers to those who regularly drink alcohol, or are drunk in a public places, and while they may have accommodation they are known to lead street based lifestyles.</p>	The process of enforcing the PSPO is solely focussed on the prohibition in the order, which is ASB linked to the consumption of alcohol in public spaces.	All ages of vulnerability will be referred into safeguarding and support provisions and mechanisms.	Community Connections.
Disability	<p>Addiction to alcohol is not a recognised disability however you might be disabled if your addiction caused an impairment. For example if you have liver disease or depression caused by alcohol dependency, that would be an impairment.</p> <p>It might also be a disability if your addiction was originally caused by medical treatment or medically prescribed drugs.</p> <p>Many alcohol dependent street drinkers have multiple complex interlinked conditions.</p> <p>This PSPO may impact those who are alcohol dependent more than other communities. This impact will be mitigated by use of a well thought out</p>	<p>The PSPO will have a positive impact as it offers a targeted support mechanism to those who are most vulnerable, and by reducing localised displacement it offers increased opportunity to offer this support.</p> <p>The process of enforcing the PSPO is</p>		

	strengths based support system which ensures needs are identified and addressed.					solely focussed on the prohibition of the order. Plymouth City Council does not expect a disability to influence the actions of the enforcement officers or the execution of the order. The treatment and process of applying the order will be the same for all. Taking into account those who are alcohol dependent and their specific need.		
Faith/religion or belief	2011 Census data					No adverse impact is anticipated	N/A	
	Residents	Count	Persons	Mar-11	256384	The process of enforcing the PSPO is solely focussed on the prohibition of the order. Plymouth City Council does not expect faith, relation or belief to influence the actions of the enforcement officers or the execution of the order. The treatment and process of applying the order will be the same for all.		
	Christian	Count	Persons	Mar-11	148917			
	Christian	Percentage	Persons	Mar-11	58.1			
	Buddhist	Count	Persons	Mar-11	881			
	Buddhist	Percentage	Persons	Mar-11	0.3			
	Hindu	Count	Persons	Mar-11	567			
	Hindu	Percentage	Persons	Mar-11	0.2			
	Jewish	Count	Persons	Mar-11	168			
	Jewish	Percentage	Persons	Mar-11	0.1			
	Muslim	Count	Persons	Mar-11	2078			
	Muslim	Percentage	Persons	Mar-11	0.8			
	Sikh	Count	Persons	Mar-11	89			
	Sikh	Percentage	Persons	Mar-11	0			
	Other Religion	Count	Persons	Mar-11	1198			
	Other Religion	Percentage	Persons	Mar-11	0.5			
	No Religion	Count	Persons	Mar-11	84295			
	No Religion	Percentage	Persons	Mar-11	32.9			
	Religion Not Stated	Count	Persons	Mar-11	18191			

	Religion Not Stated	Percentage	Persons	Mar-11	7.1			
Gender - including marriage, pregnancy and maternity	National data indicates that men are more likely to drink alcohol than women. When looking at self-reported drinking behavior by identified gender, the latest data shows that 61.9% of men and 52.4% of women drank alcohol in the week prior to interview. Looking at drinking habits by age, the highest consumption was found among those aged 45 to 64 years, with 64.6% saying they drank alcohol in the past week; the lowest was found among those aged 16 to 24 years, with 47.9% saying they drank alcohol in the past week. Currently in Plymouth 34 individuals are linked to a partnership seeking to address issues of street drinking, homelessness and/or begging. These issues are often complex and linked. Of the 34 individuals 24 are male and 10 female.					The PSPO will have a positive impact as a citywide consistent approach will allow support services to better engage those most at risk. The process of enforcing the PSPO is solely focussed on the prohibition of the order. Plymouth City Council does not expect gender to influence the actions of the enforcement officers or the execution of the order. The treatment and process of applying the order will be the same for all.	N/A	
Gender reassignment	Gender reassignment data is not available at ward level. Recent surveys have put the prevalence of transgender people between 0.5 and 1% of population (some very recent reports have upped this to 2%)					No adverse impact is anticipated The process of enforcing the PSPO is solely focussed on the prohibition of the order. Plymouth City Council does not expect gender reassignment to influence the actions of the enforcement officers or the execution of the order. The treatment and process of applying	N/A	

		the order will be the same for all.		
Race	All 256384	No adverse impact is anticipated The process of enforcing the PSPO is solely focussed on the prohibitions of the order. Plymouth City Council does not expect race to influence the actions of the enforcement officers or the execution of the order. The treatment and process of applying the order will be the same for all.	N/A	
	White: English/Welsh/Scottish/Northern Irish/British 238263			
	White: Irish 1105			
	White: Gypsy or Irish Traveller 153			
	White: Other White 6988			
	Mixed/multiple ethnic group: White and Black Caribbean 904			
	Mixed/multiple ethnic group: White and Black African 523			
	Mixed/multiple ethnic group: White and Asian 1028			
	Mixed/multiple ethnic group: Other Mixed 832			
	Asian/Asian British: Indian 875			
	Asian/Asian British: Pakistani 202			
	Asian/Asian British: Bangladeshi 359			
	Asian/Asian British: Chinese 1251			
	Asian/Asian British: Other Asian 1219			
	Black/African/Caribbean/Black British: African 1106			
	Black/African/Caribbean/Black British: Caribbean 343			
	Black/African/Caribbean/Black British: Other Black 229			
	Other ethnic group: Arab 399			
	Other ethnic group: Any other ethnic group 605			

Sexual orientation - including civil partnership	There is no precise local data on numbers of LGBTQ individuals in Plymouth, but nationally the government have estimated this to be between 5 - 7 per cent.	No adverse impact is anticipated The process of enforcing the PSPO is solely focussed on the prohibition of the order. Plymouth City Council does not expect sexual orientation to influence the actions of the enforcement officers or the execution of the order. The treatment and process of applying the order will be the same for all.	N/A	

STAGE 3: ARE THERE ANY IMPLICATIONS FOR THE FOLLOWING? IF SO, PLEASE RECORD ACTIONS TO BE TAKEN

Local priorities	Implications	Timescale and who is responsible
Reduce the gap in average hourly pay between men and women by 2020.	No adverse impact is anticipated	
Increase the number of hate crime incidents reported and maintain good satisfaction rates in dealing with racist, disablist, homophobic, transphobic and faith, religion and belief incidents by 2020.	No adverse impact is anticipated. The Council believes the introduction of the PSPO will assist in the reduction of alcohol related hate incidents and protect businesses in the local area.	
Good relations between different communities (community cohesion)	Plymouth City Council has a public duty to protect its residents, to share information and to safeguard the community. The Council believes that the PSPO will have a positive impact on the community by reducing tensions between the residents and the street drinkers.	
Human rights Please refer to guidance	<p>The following articles of the Human Rights Act have been considered:</p> <p>Article 1: Protection of Property</p> <p>Point to be considered:</p> <ol style="list-style-type: none"> 1. Every natural or legal person is entitled to the peaceful enjoyment of his possessions. No one shall be deprived of his possessions except in the public interest and subject to the conditions provided for by law and by the general principles of international law. <p>The removal of an open container of alcohol or of a vehicle could remove the right to the protection of property. However, the positive impact would be to reduce accidents and safeguard members of the public and the wider community.</p>	

Article 2: Right to Life

Point to be considered:

2.2 (b) in order to effect a lawful arrest or to prevent the escape of a person lawfully detained;

The PSPO Prohibition around nuisance drivers is recognised as positive to reduce accidents and safeguard members of the public and the wider community.

Article 6

Everyone charged with a criminal offence has the following minimum rights:

(a)to be informed promptly, in a language which he understands and in detail, of the nature and cause of the accusation against him;

Article 8: Right to respect for private and family life

Point to be considered:

8.2There shall be no interference by a public authority with the exercise of this right except such as is in accordance with the law and is necessary in a democratic society in the interests of national security, public safety or the economic well-being of the country, for the prevention of disorder or crime, for the protection of health or morals, or for the protection of the rights and freedoms of others.

Impact on an individual when having a container of alcohol removed may remove the right to a public and private life. The positive impact reduces the risk to members of the community of threat, risk and harm. It can also provide a route into support agencies.

Article 10: Freedom of expression

Point to be considered:

10.2 The exercise of these freedoms, since it carries with it duties and responsibilities, may be subject to such formalities, conditions, restrictions or penalties as are prescribed by law and are necessary in a democratic society, in the interests of national security, territorial integrity or public safety, for the prevention of disorder or crime, for the

	<p>protection of health or morals, for the protection of the reputation or rights of others, for preventing the disclosure of information received in confidence, or for maintaining the authority and impartiality of the judiciary.</p> <p>Individuals may feel their right to freedom of expression may be threatened if their alcohol is removed. The positive impact is that the removal of alcohol may modify behaviour and, where relevant, better enable support service engagement.</p>	
--	--	--

STAGE 4: PUBLICATION

Responsible Officer 

Date
14/09/2020

Director, Assistant Director or Head of Service

CITY WIDE PUBLIC SPACES PROTECTION ORDER 2020



Anti-social Behaviour, Crime and Policing Act 2014

PLYMOUTH CITY COUNCIL CITY WIDE PUBLIC SPACES PROTECTION ORDER 2020

Plymouth City Council ("the Council") makes this Order under section 59 of the Anti-social Behaviour, Crime and Policing Act 2014 (the Act) having consulted with relevant parties as required by section 72 of the Act.

The Order takes effect on [date tbc] for a period of 3 years.

The order relates to all public places within the City of Plymouth, the boundaries of which are edged black on the map and schedule of land attached to this Order at Appendix 1 ("the Restricted Area").

The Council is satisfied that anti-social behaviour and criminal activities have been carried out in the Restricted Area associated with the consumption of alcohol which have had a detrimental effect on the quality of life of those in the locality, and a detrimental effect on the City as a whole.

Further, it is satisfied that the effect of these activities is, or is likely to be, of a persistent or continuing nature, and, is, or is likely to be, such as to make the activities unreasonable and the effect therefore justifies the restrictions imposed.

The activities have given rise to nuisance and complaints to both the Council and the Police from local residents and businesses.

The effects of this Order is to impose the following prohibitions and/or requirements at all times within the Restricted Area:

1. No person shall continue to consume alcohol, or anything which is reasonably believed to be alcohol, when asked to stop by an authorised person
2. No person shall fail to surrender a vessel(s) of alcohol, sealed or unsealed when requested by an authorised officer who, in their view believe this would assist in preventing further anti-social behaviour, public nuisance or disorder

Unless:

- a) he/she has a reasonable excuse for failing to do so or
- b) the area is subject to exemptions listed in Appendix 2

An “authorised officer” means an employee of the council, Police Community Support Officer or other person who is authorised in writing by the council.

Penalty:

In accordance with Section 63 of the Act, a person who, without reasonable excuse fails to comply with this Order shall be guilty of an offence and liable on a summary conviction to a fine not exceeding level 2 (£500) on the standard scale.

Persistent breaches of the Order may also lead to additional orders being sought against perpetrators under the Act.

A police officer or an authorised person, may issue an anti-social behaviour warning to anyone he or she has reason to believe has committed an offence under section 63 in relation to this Order. Subsequent offences will result in a further warning leading to a summary conviction

Challenging the validity of the Order (section 66 of the Act)

- (1) An interested person may apply to the High Court to question the validity of—
- (a) a public spaces protection order, or
 - (b) a variation of a public spaces protection order.

“Interested person” means an individual who lives in the restricted area or who regularly works in or visits that area.

- (2) The grounds on which an application under this section may be made are—
- (a) that the local authority did not have power to make the order or variation, or to include particular prohibitions or requirements imposed by the order (or by the order as varied);
 - (b) that a requirement under this Chapter was not complied with in relation to the order or variation.
- (3) An application under this section must be made within the period of 6 weeks beginning with the date on which the order or variation is made.

Appendix 1
Schedule of Land

The order applies to all land in the administrative area of Plymouth City Council that is open to the air and to which the public are entitled to or permitted to have access (with or without payment). For the purposes of the order the land which is covered is to be treated as land which is ‘open to the air’ if it is open to the air on at least one side.

Appendix 2
Exemptions

- a) Premises authorised by a premises licence or a temporary event notice to be used for the supply of alcohol;
- b) Premises authorised by a club premises certificate to be used by the club for the supply for alcohol;
- c) A place within the curtilage of premises with paragraph (a) or (b);
- d) Premises which by virtue of Part 5 of the Licensing Act 2003 may at the relevant time be used for supply of alcohol or which, by virtue of that Part, could have been so used within the 30 minutes before that time;
- e) A place where facilities or activities relating to the sale or consumption of alcohol are at the relevant time permitted by virtue of a permission granted under section 115E Highways Act 1980 (highway-related uses).

The Common Seal of
The Council of the City of Plymouth
was hereunto affixed in the presence of

Authorised signatory

Dated

This page is intentionally left blank

PUBLIC SPACES PROTECTION ORDERS DISCHARGE ORDER 2020



Anti-social Behaviour, Crime and Policing Act 2014

PUBLIC SPACES PROTECTION ORDERS DISCHARGE ORDER 2020

Plymouth City Council (“the Council”) makes this Order under section 61 of the Anti-social Behaviour, Crime and Policing Act 2014 (the Act) having consulted with relevant parties as required by section 72 of the Act.

This Order relates to the discharge of the Council’s Public Spaces Protection Orders listed in appendix I

The Order takes effect on [date tbc] which is the date that the Council’s City Wide Public Protection Order comes into effect.

With effect from this date, the said Orders will no longer be valid.

APPENDIX I

Public Space Protections Order – City Centre and Stonehouse

Public Space Protections Order – Devonport

Public Space Protections Order – North Hill

Public Space Protections Order – Freedom Fields

Public Space Protections Order – Mutley Plain

Public Space Protections Order – Tothill Park

Public Space Protections Order – Stonehouse

The Common Seal of
The Council of the City of Plymouth
was hereunto affixed in the presence of

Authorised signatory

Dated

This page is intentionally left blank

EXECUTIVE DECISION

made by a Cabinet Member



REPORT OF ACTION TAKEN UNDER DELEGATED AUTHORITY BY AN INDIVIDUAL CABINET MEMBER

Executive Decision Reference Number – CFCS02 20/21

Decision	
1	Title of decision: Public Spaces Protection Order Control of Dogs 2020
2	Decision maker (Cabinet member name and portfolio title): Councillor Sally Haydon
3	Report author and contact details: Lindsay McClean
4	Decision to be taken: <ol style="list-style-type: none"> 1. That the current Public Spaces Protection Order – Control of Dogs 2017 is renewed and amended 2. That the current restrictions are retained in a new PSPO – Control of Dogs 2020 3. That a new requirement for a dog owner/walker to have the means to pick up after their dog is included 4. That the restriction for dogs to be kept on a lead in Area A in Central Park is included (see appendix 2 of briefing report) 5. That the restriction for dogs to be kept on a lead on the new crematorium site at Haye Road when it opens is included 6. That the wording relating to when a dog owner/walker may be ordered to put a dog on a lead by an Authorised Officers is amended
5	Reasons for decision: <p>The current Public Spaces Protection Order – Control of Dogs 2017 expires on the 19th October 2020. A PSPO needs to be reviewed every 3 years in order to extend or vary it.</p> <p>A consultation process has been undertaken to explore the views of statutory consultees and the public in relation to dog control in Plymouth. This decision is to agree a new PSPO with specific additional controls.</p>
6	Alternative options considered and rejected: <ol style="list-style-type: none"> 1. No changes to the current restrictions 2. The removal of all current restrictions

	3. Some changes to specific control, which have been rejected after consultation.		
7	Financial implications: Additional signage will be required in areas where new restrictions are introduced. It is expected that this will be in the region of £2,000.		
8	Is the decision a Key Decision? (please contact Democratic Support for further advice)	No	Per the Constitution, a key decision is one which: in the case of capital projects and contract awards, results in a new commitment to spend and/or save in excess of £3million in total in the case of revenue projects when the decision involves entering into new commitments and/or making new savings in excess of £1million is significant in terms of its effect on communities living or working in an area comprising two or more wards in the area of the local authority.
	If yes, date of publication of the notice in the Forward Plan of Key Decisions		
9	Please specify how this decision is linked to the Council's corporate plan/Plymouth Plan and/or the policy framework and/or the revenue/capital budget:	Reducing dog fouling is a priority of the Council. Having areas where dog controls are in place improves the safety of all users of the parks and open spaces within the city. Enforcement of these offences is essential to encourage compliant behaviour by dog owners/walkers. If the PSPO – Control of Dogs is not renewed, these offences will not be able to be enforced in Plymouth. The renewal of the PSPO – Control of Dogs will continue to make dog fouling and not complying with dog control measures an offence.	
10	Please specify any direct environmental implications of the decision (carbon impact)		
Urgent decisions			
11	Is the decision urgent and to be implemented immediately in the interests of the Council or the public?	Yes	(If yes, please contact Democratic Support (democraticsupport@plymouth.gov.uk) for advice)
		No	(If no, go to section 13a)
12a	Reason for urgency:		

12b	Scrutiny Chair Signature:		Date	
	Scrutiny Committee name:			
	Print Name:			
Consultation				
13a	Are any other Cabinet members' portfolios affected by the decision?	Yes	X	
		No		(If no go to section 14)
13b	Which other Cabinet member's portfolio is affected by the decision?	Councillor Sue Dann Councillor Peter Smith		
13c	Date Cabinet member consulted	30.06.20		
14	Has any Cabinet member declared a conflict of interest in relation to the decision?	Yes		If yes, please discuss with the Monitoring Officer
		No	X	
15	Which Corporate Management Team member has been consulted?	Name	Ruth Harrell	
		Job title	Director of Public Health	
		Date consulted	August 2020	
Sign-off				
16	Sign off codes from the relevant departments consulted:	Democratic Support (mandatory)	DS32 20/21	
		Finance (mandatory)	djn.20.21.89	
		Legal (mandatory)	34759/ag/16.9.2020	
		Human Resources (if applicable)		
		Corporate property (if applicable)		
		Procurement (if applicable)		
Appendices				
17	Ref.	Title of appendix		
	A	Briefing report		
	B	Equalities Impact Assessment		
	C	PSPO Consultation		
	D	Map Central Park		

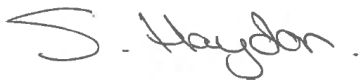
	E	Map New Crematorium						
	F	Map of dog fouling and dog control FPNs						
	G	Results of consultation						
Confidential/exempt information								
18a	Do you need to include any confidential/exempt information?	Yes		If yes, prepare a second, confidential ('Part II') briefing report and indicate why it is not for publication by virtue of Part I of Schedule 12A of the Local Government Act 1972 by ticking the relevant box in 18b below. (Keep as much information as possible in the briefing report that will be in the public domain)				
		No	X					
		Exemption Paragraph Number						
		1	2	3	4	5	6	7
18b	Confidential/exempt briefing report title:							
Background Papers								
19	Please list all unpublished, background papers relevant to the decision in the table below. Background papers are <u>unpublished</u> works, relied on to a material extent in preparing the report, which disclose facts or matters on which the report or an important part of the work is based. If some/all of the information is confidential, you must indicate why it is not for publication by virtue of Part I of Schedule 12A of the Local Government Act 1972 by ticking the relevant box.							
Title of background paper(s)		Exemption Paragraph Number						
		1	2	3	4	5	6	7
Cabinet Member Signature								
20	I agree the decision and confirm that it is not contrary to the Council's policy and budget framework, Corporate Plan or Budget. In taking this decision I have given due regard to the Council's duty to promote equality of opportunity, eliminate unlawful discrimination and promote good relations between people who share protected characteristics under the Equalities Act and those who do not. For further details please see the EIA attached.							
Signature					Date of decision		17/09/2020	
Print Name		Councillor Sally Haydon						

CREATING A NEW PUBLIC SPACES PROTECTION ORDER – CONTROL OF DOGS 2020

ODPH

**1.0 Executive Summary**

The existing Public Spaces Protection Order – Control of Dogs 2017 expires on the 19th October 2020. A PSPO needs to be reviewed every 3 years in order to renew or vary it. A consultation process has been undertaken to explore the support for dog fouling and dog control measures in specific area in Plymouth. The consultation also sought to seek views on some new and amended proposals (see Appendix I for consultation questions).

1454 responses were received

81.3% of responders were from dog owners/walkers

80.7% of responders walk dogs in Plymouth

A summary of the results of the consultation can be found in section 7, below. Further details can be found in Appendix 5.

The Council propose to amend the current PSPO to reflect the views of the majority of those who responded. It is intended that a new Public Spaces Protection Order – Control of Dogs 2020 will come into effect on the 20th October.

2.0 Background to Public Spaces Protection Orders

Public Spaces Protection Orders (PSPOs) were introduced in the Anti-social Behaviour, Crime and Policing Act 2014. The primary purpose of the PSPO is to empower local authorities to deal with anti-social behaviour that adversely affects other people using the same public space.

A PSPO may only prohibit or impose requirements that are reasonable to prevent or reduce the detrimental effect from continuing, occurring or recurring. A local authority may make a PSPO if they are satisfied that the following 2 conditions are met:

1. Activities carried out in a public place within the authority's area are having or have had a detrimental effect on the quality of life of those in the locality, or it is likely that the activities will be carried out in a public place within that area and they will have such an effect
2. The effect or likely effect of the activity:
 - Is or is likely to be of a persistent or continuing nature
 - Is or is likely to be such as to make the activities unreasonable, and
 - Justifies the restrictions imposed by the notice

Local authorities should consider that the requirements and prohibitions are reasonable. When drafting an Order placing restrictions on dogs, Councils should consider the need for owners to exercise their dogs. If a PSPO restricts access to land used to exercise dogs, it would be reasonable that there is sufficient other land available for exercise without restrictions. (LGA Public Spaces Protection Order Guidance for councils)

A person will commit an offence if they do something that is prohibited or fails to comply with a PSPO. Anyone who has breached a PSPO can be issued with a Fixed Penalty Notice of £100 giving the person 14 days to pay the fine.

A PSPO can be put in place for up to 3 years. Then the PSPO must be reviewed to ensure it is still necessary. Before extending or varying the PSPO, local authorities must consult with the local chief of police, the police and crime commissioner, owners or occupiers of land within any affected area and appropriate community representatives. The new PSPO will remain in force for a further 3 years.

In accordance with the Anti-social Behaviour, Crime and Policing Act 2014 (Publication of Public Spaces Protection Orders) Regulations 2014, the local authority must publish the order as made, extended or varied on its website and erect appropriate notices on or adjacent to the public place to which the order relates.

3.0 Current Public Spaces Protection Order – Control of Dogs 2017

The current dog control measures in Plymouth can be found in the Public Spaces Protection Order – Control of Dogs 2017, which took over the controls found within the previously enacted Dog Control Orders 2008.

The PSPO – Control of Dogs 2017 specifies four offences:

1. Failing to remove dog poo straight away
2. Not putting a dog on a lead when ordered to do so by an authorised officer
3. Allowing a dog to enter land from which they are excluded
4. Not keeping a dog on a lead where this is required

The land to which these restrictions apply are detailed in the Order. The published 2017 Order can be found on the Council's website: <https://www.plymouth.gov.uk/animalsandpests/dogcontrol>

4.0 Internal review of the PSPO – Control of Dogs 2017

Meetings were held with a number of relevant internal departments and Portfolio Holders.

It was considered that the existing offences relating to dog fouling and the control of dogs in the specified areas in Plymouth should remain in place in a new PSPO.

It was considered that the Council should consult on the following new/amended proposals:

1. To require a dog owner/walker to have the means to pick up their dog's faeces.
2. To require dogs to be kept on a lead within two areas of Central Park that would be an extension of the current restricted area
3. To require dog control restrictions all year round on all sports facilities
4. To consider what the dog control restriction should be on sports facilities
5. To require dogs to be kept on a lead within the site of the new crematorium at Haye Road, Plymouth, when it is opened.
6. To change the wording when dogs are required to be put on a lead by an Authorised Officer.

5.0 Reasons for the proposed changes to the PSPO – Control of Dogs

1. To require a dog owner/walker to have the means to pick up their dog's faeces.

The Council received the following number of dog fouling complaints across the city:

2017/18 – 545

2018/19 – 434

2019/20 – 522

2020/21 – 152 (part year)

(see Appendix 4 for a map showing the location of dog fouling complaints Feb 19 to Aug 20)

The majority of dog owners/walkers carry dog poo bags to pick up and dispose of their dogs faeces. The introduction of this requirement is aimed at encouraging dog owners/walkers to consider how they will pick up their dog faeces which will help to reduce the incidence of dog fouling which is affecting the residents in Plymouth.

Carrying a means to pick up faeces is not considered unreasonable as this can be done with specific dog poo bags which are small, lightweight and can be carried in a pocket or small container attached to a dog's lead.

2. To require dogs to be kept on a lead within an area of Central Park that is an extension of the current restricted area.

Central Park has recently undergone an extensive improvement programme as part of the Council's Central Park Masterplan. The aim was to build a premier park for the people of Plymouth and outstanding venue of regional and national significance for active recreation and formal sport, culture, art and the natural environment. In 2017, it was agreed that dogs must be kept on a lead in the area that was being developed for family play, skating and around the specific sports facilities of bowling and tennis.

Internal discussions suggested that the current restricted area could be extended to provide a larger area within Central Park where dogs must be on a lead, as these were areas of mixed use.

2 areas were proposed which would extend the restrictions to the north and/or the south of the area where current restrictions apply. (see map in Appendix 2)

Area A – north of the existing restricted area, including the field outside the Life Centre, the adjacent field which contains a sports pitch, the pedestrian area outside the Life Centre and the carpark. This is an area of high footfall and mixed use and is the first area of the Central Park that people enter from the carpark. It is also the access route for vehicles to the Events field, catering establishments in Central Park and the main route for maintenance vehicles.

Area B – south of the existing restricted area, including the Sports Hub and fields containing a range of sports facilities, including golf, football, baseball and lacrosse pitches. This is an area of mixed use, where currently only the marked sports pitches require dogs to be on a lead.

It was considered appropriate to consult on introducing restrictions in these areas.

3. To require dog control restrictions all year round on all sports facilities

The requirement for dogs to be on a lead on sports pitches has been a control measure since 2008, introduced to assist with tackling dog fouling in areas which are specifically designated for a sporting activity. These areas are used for formal matches within a league structure and by people making use of these sporting facilities informally at other times. Therefore, it is essential that these areas are clear from dog fouling to minimise the risk to health at all times. (see Appendix 4 for map showing where Fixed Penalty Notices have been served for dog fouling and dogs not on a lead when required)

Consideration was given to the maintenance of the pitches and grass cutting operations in these areas and the ground marking that were required for the sports. For example, within a large playing field there can be several individual sports pitches and the exact location of a marked pitch can be moved in order to maintain the appropriate playing surface. In addition, the pitches are only marked up when required for the relevant sport, e.g. in the football/rugby season.

Complaints are received by the Council in relation to dog fouling on sports pitches across the city. As dog fouling can be an issue on sports pitches throughout the year, it was considered appropriate to consult on introducing restrictions on sports facilities throughout the year.

4. To consider what the dog control restriction should be on sports facilities

Further to the internal discussions detailed above, consideration was also given as to whether the existing restriction in relation to sports facilities should remain, in that dogs are kept on a lead on sports pitches. Alternatively, dogs could be excluded from these areas or the restrictions could be removed.

It was considered appropriate to seek views on what restriction, if any, should be in place on sports facilities.

5. To require dogs to be kept on a lead within the site of the new crematorium at Haye Road, Plymouth, when it is opened.

Internal discussions were held with the Bereavement Service regarding the new crematorium site at Haye Road. (see Appendix 3 for map of the new crematorium site) This is due to be opening before the new PSPO would expire. It was considered reasonable that dogs should be kept on a lead at this site, to prevent disturbance to non-dog owners whilst on site and to minimise the risk of dog fouling not being picked up by dog owners.

Therefore, it was considered appropriate to consult at this time on the proposed restrictions in order that could be put in place in time for the opening of this facility.

6. To change the wording when dogs are required to be put on a lead by an Authorised Officer.

Under the current PSPO, if a dog's behaviour is causing a nuisance, annoyance or disturbance to any person, animal or bird and it needs to be on a lead to prevent this, the owner/walker may be asked to put it on a lead.

Internal discussions were held with Legal Services on the wording of the existing offence to put a dog on a lead when directed by an Authorised Officer. It was considered that the wording should be

amended and updated in line with the requirements of the Anti-Social Behaviour, Crime and Policing Act 2014 under which the PSPOs are made.

It is proposed that the wording is amended, such that a dog owner/walker will be required to put their dog on a lead if such restraint is reasonably necessary to prevent a nuisance or if its behaviour is likely to cause alarm, distress or disturbance to any other person or animal or bird.

It was considered appropriate to consult on the changes to this wording for the new PSPO.

6.0 External consultation for renewing and varying the PSPO – Control of Dogs

The external consultation has been carried out in accordance with the LGA Public Spaces Protection Order Guidance for councils. Any proposed extension or variation of the existing PSPO requires consultation with statutory consultees and the public.

The details of the consultation were put on the Council's website, social media Facebook and Twitter accounts and in the Herald. Notices were put up in the areas of Central Park that could be directly affected by the introduction of restrictions in an extended area.

Consultation details were sent to the Devon and Cornwall Police and Crime Commissioner, the Chief Officer of Police, the local Police inspector for Peverell and Hartley, the Kennel Club, Gables Farm Dogs and Cats Home and local veterinary practices.

Details were sent to all Friends of Parks organisations across the city, the Meadow Café, the Life Centre and local sports clubs, including the Central Park golf club, football, rugby and cricket organisations and Plymouth University and Marjons College that use the Council's sports facilities.

Details were sent to all Members and relevant internal departments, including Anti-Social Behaviour, Street Services, Natural Infrastructure, Sports Development and the Legal Department.

7.0 Results of Consultation

1454 responses were received. This level of response (over 1100) makes this consultation statistically robust.

81.3% of responders were from dog owners/walkers.

80.7% of responders walked dogs in Plymouth

The questions asked responders whether they supported retaining the existing dog fouling offence and dog control measures. They were also to seek views on some proposed new or amended dog control measures.

7.1 Existing dog fouling and dog control measures

Question	Result	Recommendation
Do you agree that dog owners/walkers should pick up their dog's poo?	Yes – 99.8% No – 0.2%	Retain the existing offence in the new PSPO

Do you agree that dogs should be excluded from the existing exclusion areas?	Yes – 86.9% No – 13.1%	Retain the existing control measure in the new PSPO
Do you agree that dogs should be excluded from Efford and Weston Mill Cemeteries?	Yes – 63.5% No – 36.5%	Retain the existing control measure in the new PSPO
Do you agree that dogs should be on a lead within the existing controlled parks?	Yes – 69.8% No – 30.2%	Retain the existing control measure in the new PSPO

Table I

Table I shows there was significant support for retaining the existing dog controls in Plymouth. Therefore, a new Public Spaces Protection Order – Control of Dogs will need to be enacted when the current PSPO expires on the 19th October 2020.

7.2 Proposed new / amended dog control measures

Question	Result	Recommendation
Do you agree that dog owners/walkers should carry something to pick up their dog's poo, e.g. poo bags?	Yes – 95.1% No – 4.9%	Include a new offence in the new PSPO
Do you agree that dogs should be kept on a lead in Area A in Central Park?	Yes – 55.3% No – 44.7%	Include this area in the new PSPO as one where dogs must be kept on a lead
Do you agree that dogs should be kept on a lead in Area B in Central Park?	Yes – 23.8% No – 76.2%	Do not include this area in the new PSPO
Do you think the current restriction should be in place all year round on all sports facilities?	Yes – 41.7% No – 58.3%	Retain the existing control measure in the new PSPO
Do you think dogs should be on a lead or excluded from sports facilities?	On a lead – 47.5% Excluded – 20.2% Neither – 32.3%	Retain the existing control measure in the new PSPO
Do you think that dogs should be kept on a lead on the new crematorium site in Plymouth?	Yes – 88.5% No – 11.5%	Include this area in the new PSPO as one where dogs must be kept on a lead
Do you agree with the proposed wording for when a dog should be put on a lead if requested to do so by an Authorised Officer in such circumstances?	Yes – 87.1% No – 12.9%	Replace the existing offence with the updated wording in the new PSPO

--	--	--

Table 2

Table 2 shows there were mixed responses to the proposals which would introduce new or amended control measures. From an analysis of the responses it is clear which ones are supported and which ones are not supported.

8.0 Recommendations

The Council have undertaken the required consultation process to extend and vary the existing Public Spaces Protection Order – Control of Dogs 2017.

The views of the responders have been taken into account and are reflected in the new draft PSPO.

It is recommended that the proposals which have been supported are included in the new Public Spaces Protection Order – Control of Dogs 2020.

The new Order will be published on the Council’s website. Signage will be installed in appropriate places to highlight the new restrictions.

This page is intentionally left blank

EQUALITY IMPACT ASSESSMENT

Environmental Protection Service



STAGE 1: WHAT IS BEING ASSESSED AND BY WHOM?

What is being assessed - including a brief description of aims and objectives?	<p>Public Spaces Protection Order – Control of Dogs 2020</p> <p>The existing Public Spaces Protection Order – Control of Dogs 2017 expires on the 19th October 2020. A PSPO needs to be reviewed every 3 years in order to renew or vary it.</p> <p>A consultation process has been undertaken to seek views on dog control measures in specific areas in Plymouth.</p> <p>A new PSPO will be enacted on the 20th October 2020. Fixed Penalty Notices of £100 may be served on a dog owner/walker who does not comply with the Order in relation to dog fouling or dog control offences.</p>
Author	Lindsay McClean
Department and service	Environmental Protection Service, ODPH
Date of assessment	10.09.2020

STAGE 2: EVIDENCE AND IMPACT

Protected characteristics (Equality Act)	Evidence and information (eg data and feedback)	Any adverse impact See guidance on how to make judgement	Actions	Timescale and who is responsible
Age	Policy has impact on individuals not groupings and only then if they commit an offence	No adverse impact is anticipated	N/A	N/A

Disability	Policy has impact on individuals not groupings and only then if they commit an offence	Nothing in the PSPO Control of Dogs applies to a person who (a) Is registered as a blind person in a register compiled under section 29 of the National Assistance Act 1948; or (b) Has a disability which affects his mobility, manual dexterity, physical coordination or ability to lift, carry or otherwise move everyday objects, in respect of a dog trained by a prescribed charity and upon which he relies for assistance.	N/A	N/A
Faith/religion or belief	Policy has impact on individuals not groupings and only then if they commit an offence	No adverse impact is anticipated	N/A	N/A
Gender - including marriage, pregnancy and maternity	Policy has impact on individuals not groupings and only then if they commit an offence	No adverse impact is anticipated	N/A	N/A
Gender reassignment	Policy has impact on individuals not groupings and only then if they commit an offence	No adverse impact is anticipated	N/A	N/A
Race	Policy has impact on individuals not groupings and only then if they commit an offence	Persons who do not speak English may not understand notices.	Visual notices will be put up in relevant places	October 2020 by Street Services
Sexual orientation - including civil partnership	Policy has impact on individuals not groupings and only then if they commit an offence	No adverse impact is anticipated	N/A	N/A

STAGE 3: ARE THERE ANY IMPLICATIONS FOR THE FOLLOWING? IF SO, PLEASE RECORD ACTIONS TO BE TAKEN

Local priorities	Implications	Timescale and who is responsible
Reduce the gap in average hourly pay between men and women by 2020.	N/A	N/A
Increase the number of hate crime incidents reported and maintain good satisfaction rates in dealing with racist, disablist, homophobic, transphobic and faith, religion and belief incidents by 2020.	N/A	N/A
Good relations between different communities (community cohesion)	N/A	N/A
Human rights Please refer to guidance	N/A	N/A

STAGE 4: PUBLICATION

Responsible Officer – Nicola Horne

Date 22nd September 2020

Strategic Director, Service Director or Head of Service

Sarah Lees

This page is intentionally left blank

PUBLIC SPACES PROTECTION ORDER – CONTROL OF DOGS 2020



Plymouth City Council

The Anti-Social Behaviour, Crime and Policing Act 2014

Public Spaces Protection Order – Control of Dogs 2020

This Order is made by Plymouth City Council (“the Council”) under the Anti-Social Behaviour, Crime and Policing Act 2014 section 59 (“the Act”) for the Control of Dogs in its area (“the Order”).

This Order comes into force on the 20th October 2020 for a period of 3 years.

General provision

1. “Public Place” means all land in the administrative area of the Council to which the public or a section of the public has access, on payment or otherwise, as a right by virtue of express or implied permission.
2. “Authorised Person” means a person authorised by the Council for the purposes of giving directions under this Order.
3. A person who habitually has a dog in his possession shall be taken to be in charge of the dog at any time unless at that time some other person is in charge of the dog.

Penalty

4. A person who fails to comply with any obligation imposed by this Order is guilty of a criminal offence by virtue of section 67(1) of the Act and liable to a fine on summary conviction not exceeding level 3 on the standard scale.

Obligations on persons with dogs

5. Fouling

- 5.1 If a dog defecates at any time in any Public Place a person who is in charge of the dog at that time must remove the faeces forthwith unless -
 - (a) he has a reasonable excuse for failing to do so; or
 - (b) the owner, occupier or other person or authority having control of the Public Place has consented (generally or specifically) to his failing to do so.

- 5.2 Placing the faeces in a receptacle which is provided for the purpose, or the disposal of waste, shall be sufficient removal from the Public Place.
- 5.3 Being unaware of the defecation (whether by reason of not being in the vicinity or otherwise), or not having a device for or other suitable means of removing the faeces shall not be a reasonable excuse for failing to remove the faeces.

6. Dog on Leads by Direction

- 6.1 An Authorised Person may in any Public Place other than those specified in Schedules 1 and 2 of this Order (which dogs are excluded from or must be kept on a lead in any event) direct a person in charge of a dog to put and keep the dog on a lead if such restraint is in the opinion of the Authorised Person reasonably necessary to prevent a nuisance or if its behaviour is likely to cause alarm, distress or disturbance to any other person or animal or bird.
- 6.2 A person issued with a direction under 6.1 must comply unless –
 - (a) he has a reasonable excuse for failing to do so; or
 - (b) the owner, occupier or other person or authority having control of the Public Place has consented (generally or specifically) to his failing to do so.

7. Exclusion of Dogs

- 7.1 A person in charge of a dog must not take it onto, or permit the dog to enter or to remain on any Public Place specified in Schedule 1 to the Order unless –
 - (a) he has a reasonable excuse for failing to do so; or
 - (b) the owner, occupier or other person or authority having control of the Public Place has consented (generally or specifically) to his failing to do so.

8. Dogs on Leads

- 8.1 A person in charge of a dog in any Public Place specified in Schedule 2 to this Order must keep the dog on a lead unless –
 - (a) he has a reasonable excuse for failing to do so; or
 - (b) the owner, occupier or other person or authority having control of the Public Place has consented (generally or specifically) to his failing to do so.

9. Means to Remove Dog Faeces

- 9.1 A person in charge of a dog in any Public Place must produce a device, or other suitable means, for removing dog faeces and transporting it to a bin (whether or not the dog has defecated) when asked to do so by an authorised officer unless –
- (a) he has a reasonable excuse for failing to do so; or
 - (b) the owner, occupier or other person or authority having control of the Public Place has consented (generally or specifically) to his failing to do so

10. Exemptions

- 10.1 Nothing in paragraph 5 (Fouling) or paragraph 7 (Exclusion of Dogs) or paragraph 9 (Means to remove dog faeces) of this Order applies to a person who –
- (a) is registered as a blind person in a register compiled under section 29 of the National Assistance Act 1948; or
 - (b) has a disability which affects their mobility, manual dexterity, physical coordination or ability to lift, carry or otherwise move everyday objects and who relies upon a dog trained by a prescribed charity and upon which he relies for assistance.
 - (c) Each of the following is a “prescribed charity”
 - i. Dogs for the Disabled (registered charity number 700454)
 - ii. Support Dogs (registered charity number 1088281)
 - iii. Caine Partners for Independence (registered charity number 803680)
- 10.2 Nothing in paragraph 7 (Exclusion of Dogs) of this Order applies to a person who –
- (a) is deaf, in respect of a dog trained by Hearing Dogs for Deaf People (registered charity number 293358) and upon which he relies for assistance.

The COMMON SEAL of the

COUNCIL OF THE CITY OF

PLYMOUTH was hereunto affixed

this day of 2020

in the presence of

Plymouth City Council Authorised Signatory

Schedule 1 – Dog Exclusion

1. All Public Places within the Council's administrative area signed at its entrance(s) as a 'dog exclusion area' (whether the sign uses those particular words and/or symbols having like effect) comprising of any fenced, hedged, walled or otherwise enclosed children's play area (owned and/or managed by the Council), bowling green, croquet lawn, tennis court, skate park, putting green, crazy golf or school grounds.
2. Efford Cemetery and Weston Mill Cemetery

Schedule 2 – Dogs on Leads

1. All Public Places within the administrative area of Plymouth City Council comprising of all Plymouth City Council owned and/or managed sports pitches when within the marked pitch/playing area.
2. Pounds House Gardens, Plymouth (shown on Plan 1 attached)
3. West Hoe Park, Plymouth (shown on Plan 2 attached)
4. Moor View Park, Mutley, Plymouth (shown on Plan 3 attached)
5. Stoke Damerell Park, Stuart Road, Stoke, Plymouth (shown on Plan 4 attached)
6. Houndiscombe Park, Mutley, Plymouth (shown on Plan 5 attached)
7. Thorn Park, Mutley, Plymouth (shown on Plan 6 attached)
8. Specified area within Central Park (shown on Plan 7 attached)
9. Crematorium, Haye Road, Plymouth (shown on Plan 8 attached)



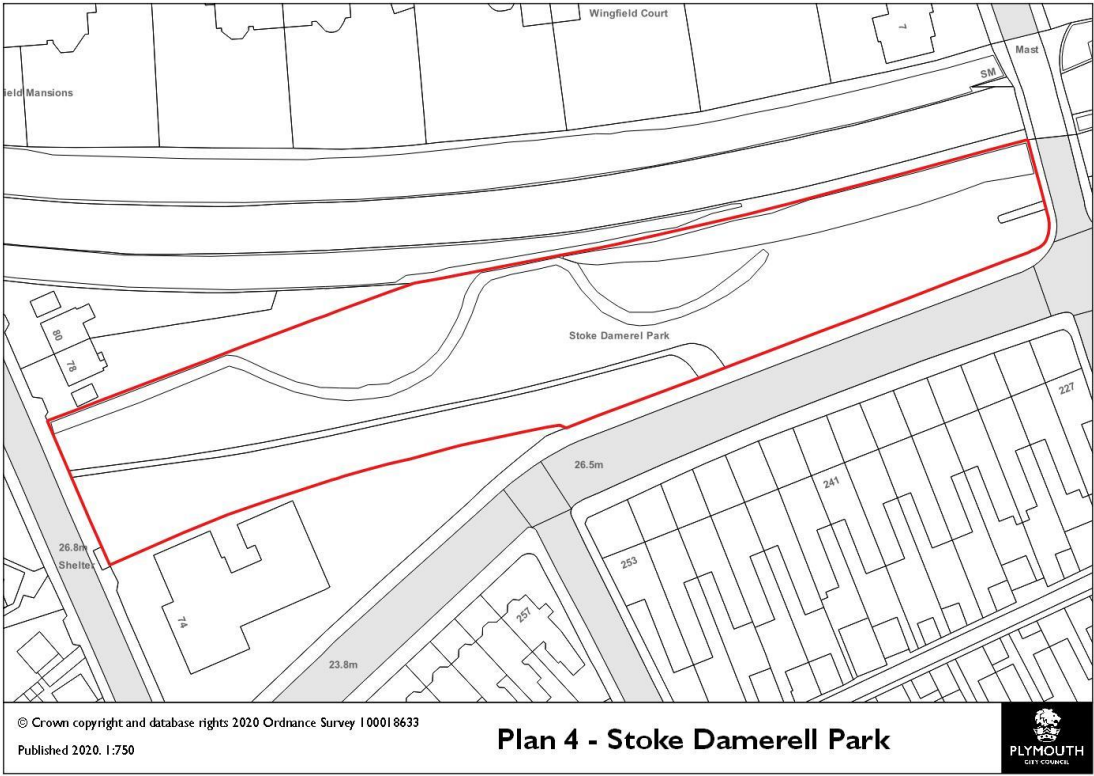
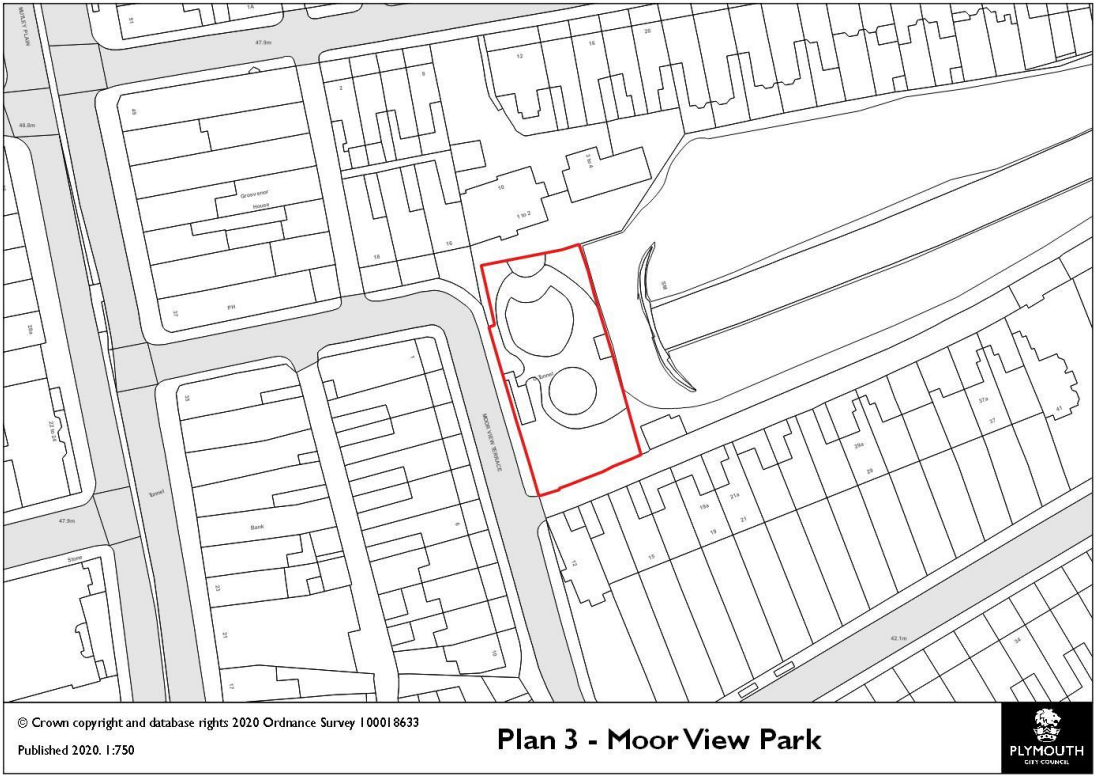

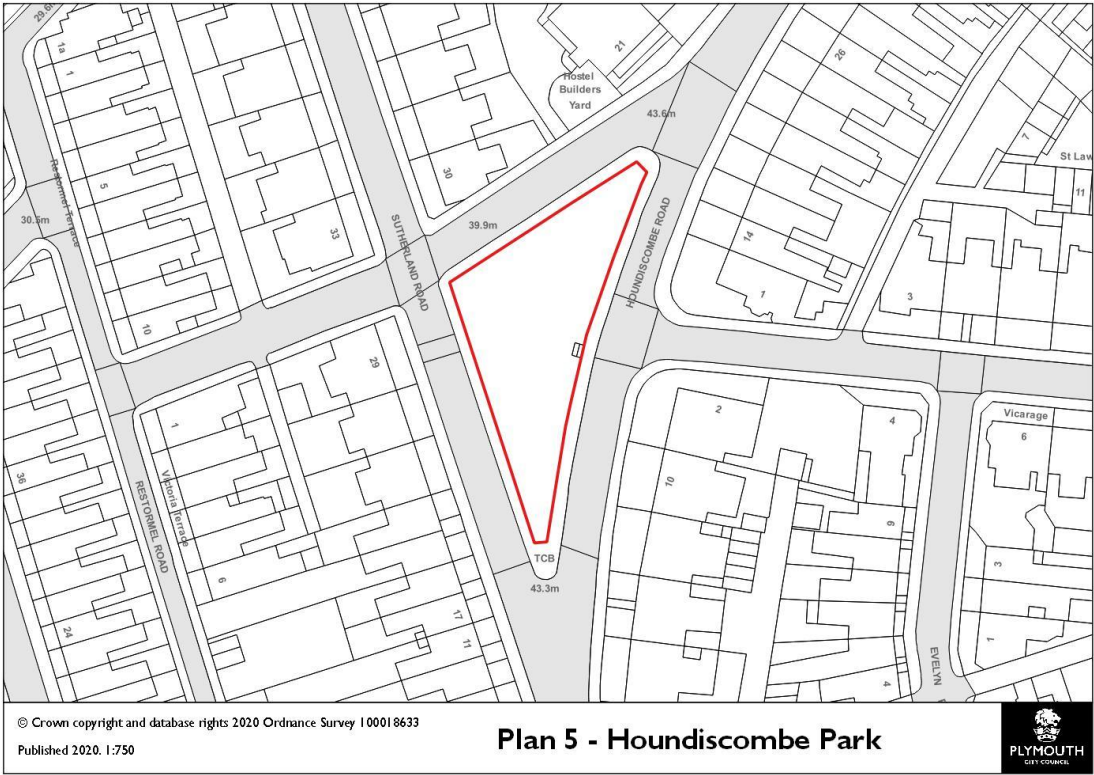

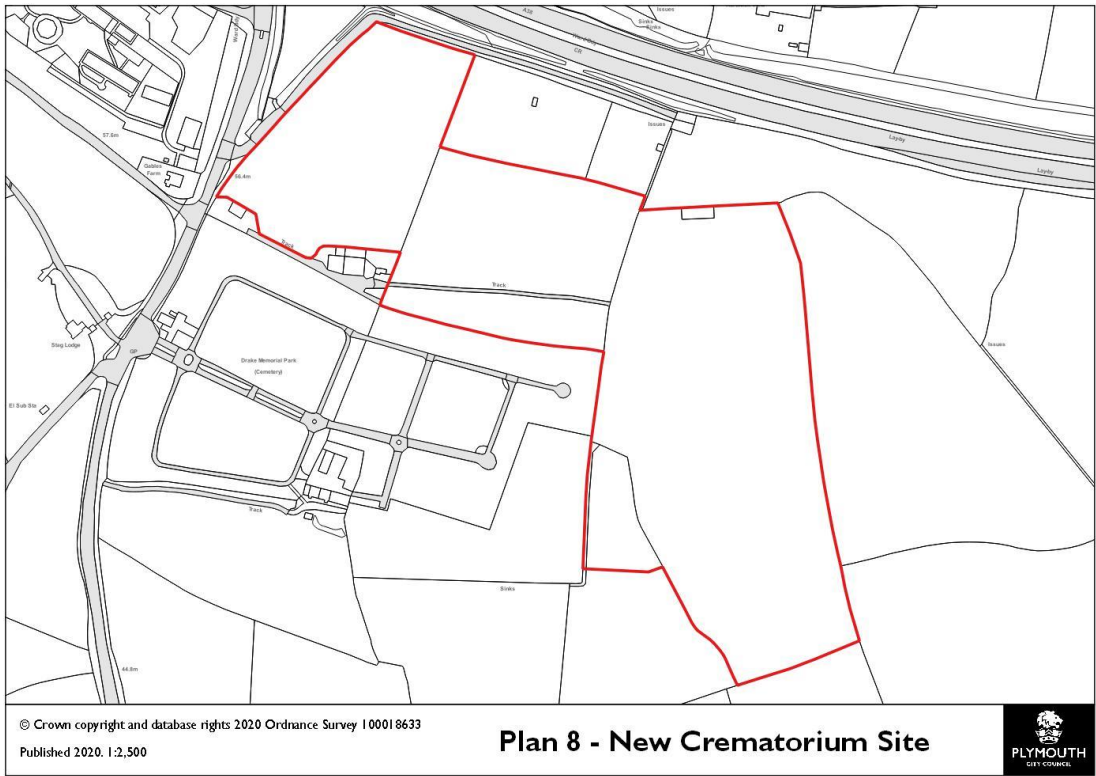
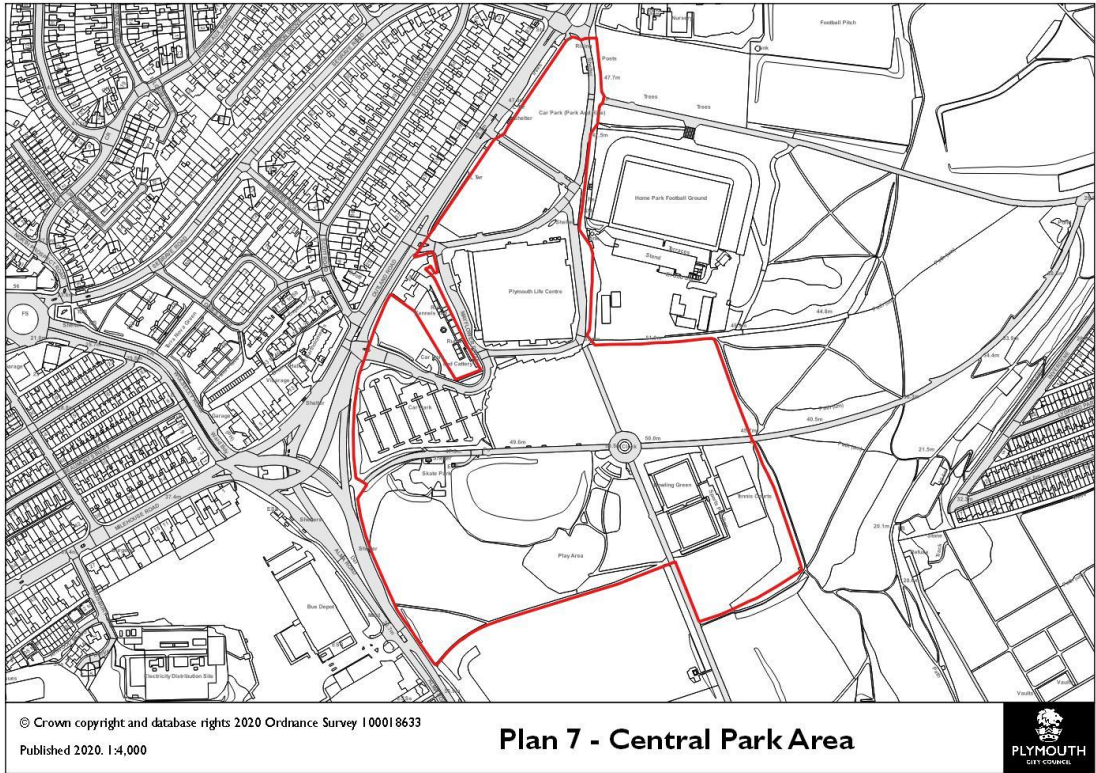

Appendix I Public Spaces Protection Order – Control of Dogs Consultation 2020

Introduction

Public Spaces Protection Orders (PSPO) are control measures, created by the Anti-Social Behaviour, Crime and Policing Act 2014, intended to deal with specific activities in a defined area that are:

- Detrimental to the local community's quality of life, and
- Persistent or continuing in nature, and
- Unreasonable

The Public Spaces Protection Order – Control of Dogs 2017 makes it an offence for dog owners/walkers not to pick up their dog's poo and details the areas where dogs are not allowed or must be on a lead. If dog owners/walkers do not comply with the Order, they face a Fixed Penalty Notice of £100 or prosecution.

Details can be found on the Council's [website](#).

The PSPO must be reviewed every 3 years. The purpose of this consultation is to seek views on the Council's intention to continue the existing Order and its proposal to introduce some changes to the areas and wording of the restrictions.

The parks and open spaces within Plymouth are not only used by dog walkers but also families, walkers, joggers, cyclists and those involved with sporting activities. The purpose of the Order is primarily to prevent dog fouling, but also to ensure that dogs are controlled at all times and especially in areas of mixed use.

The proposed Order is based on the controls that have been in place since 2008 (previously known as Dog Control Orders). It is centred on improving and protecting the local area for residents and visitors to the city and it links to other Council Strategies on improving the parks and open spaces for all users.

The new Order intends to keep the existing controls:

- Prohibiting dog fouling in all 'open air' areas
- Excluding dogs from certain areas
- Requiring dogs to be on a lead in certain areas
- Requiring dogs to be put on a lead when requested to do so by an Authorised Officer

The new proposals are:

- Requiring dog owners/walkers to always carry something to pick up their dog's poo, e.g. poo bags
- Extending the area of Central Park where dogs are required to be on a lead
- Restricting dogs on sports facilities all year round by either being on a lead or being excluded from these areas
- Requiring dogs to be on a lead at the new crematorium site when it is open

- Rewording when a dog owner/walker can be told to put their dog on a lead

The consultation is open from Friday 10 July 2020 to Sunday 2 August 2020.

Part A – Dog fouling

Dog owners/walkers are currently required to pick up dog faeces after their dog fouls. This applies to all open land to which the public are entitled and permitted to have access, with or without payment. Forestry commission land is excluded. Bins are provided in certain locations, but if there is no bin, you must take it home with you. Assistance dogs are exempt from this requirement.

It is intended to keep the existing controls relating to dog fouling:

- You must pick up your dog's faeces

1. Do you agree that dog owners/walkers should pick up their dog's poo?

Yes / No

The proposed PSPO includes a new requirement in relation to having the means to pick up dog faeces:

- You must always have something to pick up the faeces with, e.g. bags, and produce evidence of this if asked by an Authorised Officer

2. Do you agree that dog owners/walkers should carry something to pick up their dog's poo, e.g. poo bags?

Yes / No

If no – please give your reasons

Part B – Dogs exclusion

This is a control measure to protect the health and safety of people using some of our specific facilities in Plymouth, so dogs are currently excluded from them. It is intended to keep the existing controls relating to these facilities:

- You are not allowed to let your dog enter any children's play area, bowling green, croquet lawn, skate park, putting green, crazy golf or school grounds that are totally enclosed and have exclusion signs at the entrances.

3. Do you agree that dogs should be excluded from these areas?

Yes / No

Dogs are currently excluded from Efford Cemetery and Weston Mill Cemetery. It is intended to keep this restriction:

- You are not allowed to let your dog enter Efford Cemetery and Weston Mill Cemetery

4. Do you agree that dogs should be excluded from Efford and Weston Mill Cemeteries?

Yes / No

Part C – Dogs on leads

This is a control measure to assist with tackling dog fouling in specific areas. These areas are small, family orientated or ornamental parks, or are for sporting activities:

CI Parks

In the following parks, dogs are currently required to be on a lead. It is intended that this restriction remains in the proposed PSPO.

- Pounds Park
- West Hoe Park
- Moor View Park
- Stoke Damerell Park
- Houndiscombe Park
- Thorn Park

5. Do you agree that dogs should be on a lead within these parks?

Yes / No

If no – please give your reasons

In the area of Central Park (shown in Map below), dogs are required to be on a lead. This specific area and the surrounding area of Central Park have recently undergone significant development and improvement in line with our Council strategies relating to the use of open spaces, including Plymouth's Green Spaces Strategy.

Therefore, the dog controls in Central Park have been reviewed. It is proposed that the area where dogs are required to be on a lead is extended. Your views are being sought on 2 options:

Option 1 – the proposal is for dogs to be required to be kept on a lead in the car park and the fields between the current restricted area and the Life Centre known as the Central Area (Area A)

Option 2 – the proposal is for dogs to be required to be kept on a lead to include the fields to the south of the current restricted area known as the Southern Slopes Area (Area B)

6. Do you agree that dogs should be kept on a lead in Area A?
Yes / No

Please give your reasons

7. Do you agree that dogs should be kept on a lead in Area B?
Yes / No

Please give your reasons

C2 Sports Facilities

This section relates to all sports facilities in Plymouth that are owned or managed by the Council.

The requirement for dogs to be on a lead on sports pitches is a control measure to assist with tackling dog fouling in areas which are specifically designated for a sporting activity. These areas are used for formal matches within a league structure and by people making use of these sporting facilities informally at other times. Therefore, it is essential that these areas are clear from dog fouling to minimise the risk to health at all times.

Dogs are currently required to be on a lead on a marked sports pitch. Your views are being sought on the restrictions being in place all year round and on all sports facilities, including pitches and athletics tracks. You are also asked whether you think the restrictions should be changed to require dogs to be excluded from sports pitches.

8. Do you think this restriction should be in place all year round on all sports facilities?

Yes / No

Please give your reasons

9. Do you think dogs should be on a lead or excluded from sports facilities?

On a lead / Excluded / Neither

Please give your reasons

C3 New Crematorium Site

Plymouth City Council is developing a new crematorium at Haye Road, Plymouth. It is proposed that dogs should be required to be kept on a lead on this site when it is open to the public.

10. Do you think that dogs should be kept on a lead on the new crematorium site in Plymouth?

Yes / No

Please give your reasons

Part D – Dogs on leads by direction

Under the current PSPO, if your dog's behaviour is causing a nuisance, annoyance or disturbance to any person, animal or bird and it needs to be on a lead to prevent this, you may be asked to put your dog on a lead.

The Council want to clarify when dog owners or walkers must put their dog on a lead. The proposed PSPO will require a dog owner or dog walker to put their dog on a lead in order to prevent a detrimental effect on the quality of life of those in the locality and minimise the risk to the health and safety of other people or animals who are using the parks and open spaces. For example, you may be asked to put your dog on a lead to control its behaviour or to ensure it is under control during specific events being held in that area or to ensure social distancing, if required.

- You will be required to put your dog on a lead by an Authorised Officer if such restraint is reasonably necessary to prevent a nuisance or if its behaviour is likely to cause alarm, distress or disturbance to any other person or animal or bird

11. Do you agree that, in these circumstance, a dog should be put on a lead if requested to do so by an Authorised Officer in such circumstances?

Yes / No

If no - please give your reasons:

Part E – Additional questions

12. Do you have any alternative or additional proposals on dog control?

Yes / No

If yes – please give reasons

13. Are there any additional areas that you feel should be added or removed from the proposed PSPO?

Yes / No

If yes – please give reasons

14. Are there any adverse impacts to the proposals that you wish to highlight?

Yes / No

If yes – please give reasons

15. Do you own or walk dogs?

Yes / No

16. Do you walk dogs in Plymouth?

Yes / No

Ready to submit

Take a moment to review the details you have provided above. Once you are happy with this, click the 'Submit' button below to send your response to our Public Protection team

Your response will be used to inform the decision on whether to implement a new Public Spaces Protection Order and the precise restrictions in it.

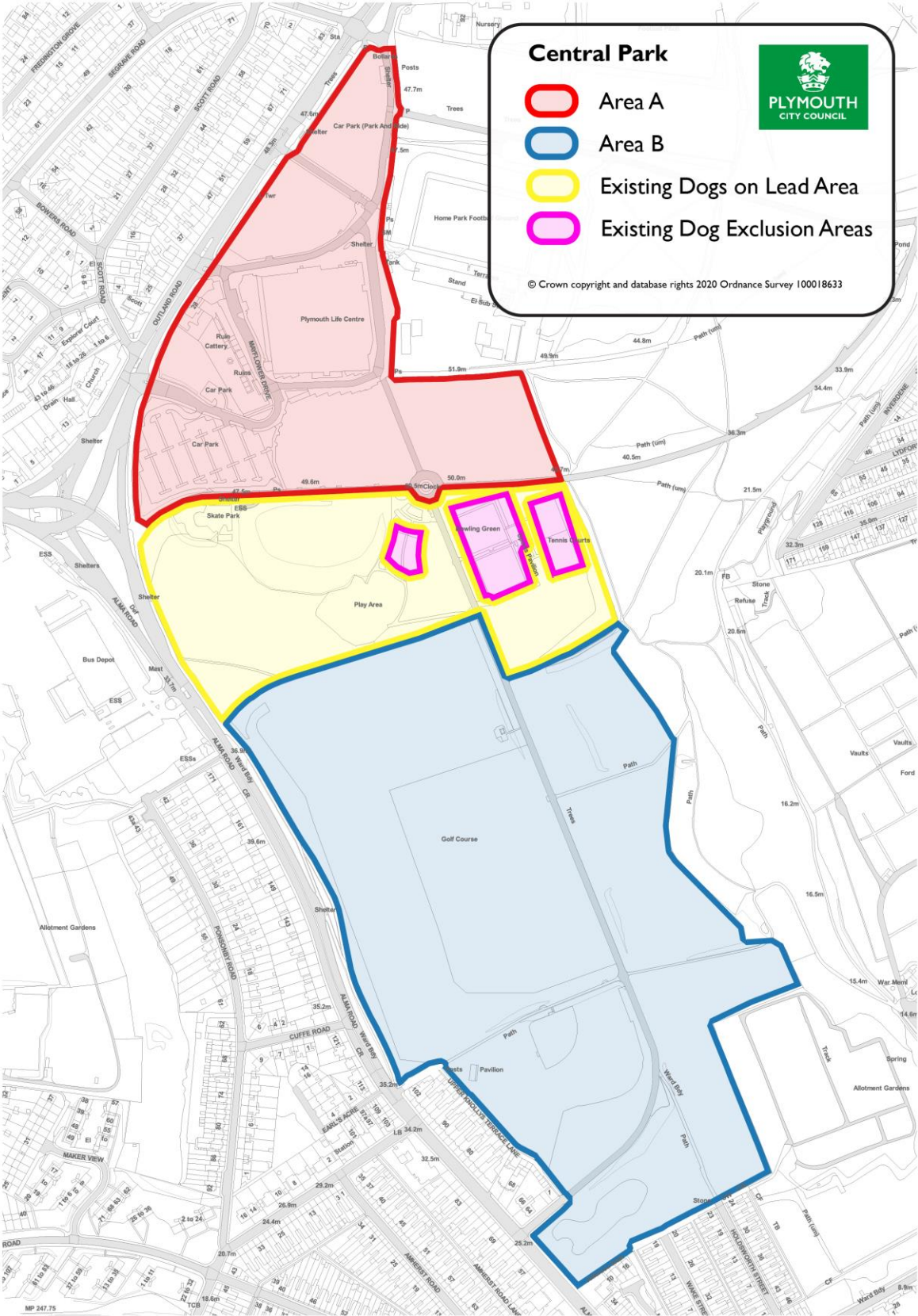

This page is intentionally left blank

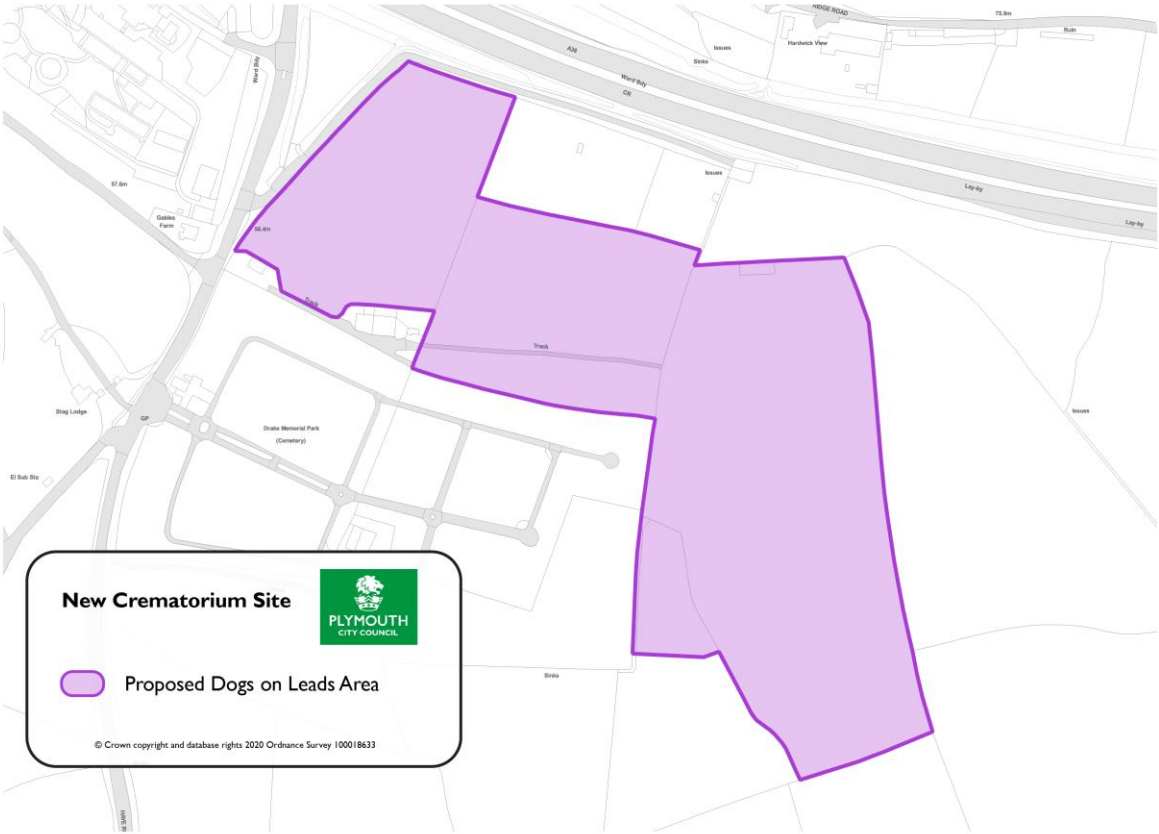

This page is intentionally left blank

Appendix 4**Map showing:****Dog Fouling complaint in Plymouth****Fixed Penalty Notices issued for dog fouling****Fixed Penalty Notices issued for dogs not on a lead in an areas where this is required**

February 2019 to August 2020:

Brown - dog fouling complaints – 753

Red – FPNs for dog fouling – 8

Blue – FPNs for Dogs not on a lead where this is required – 163

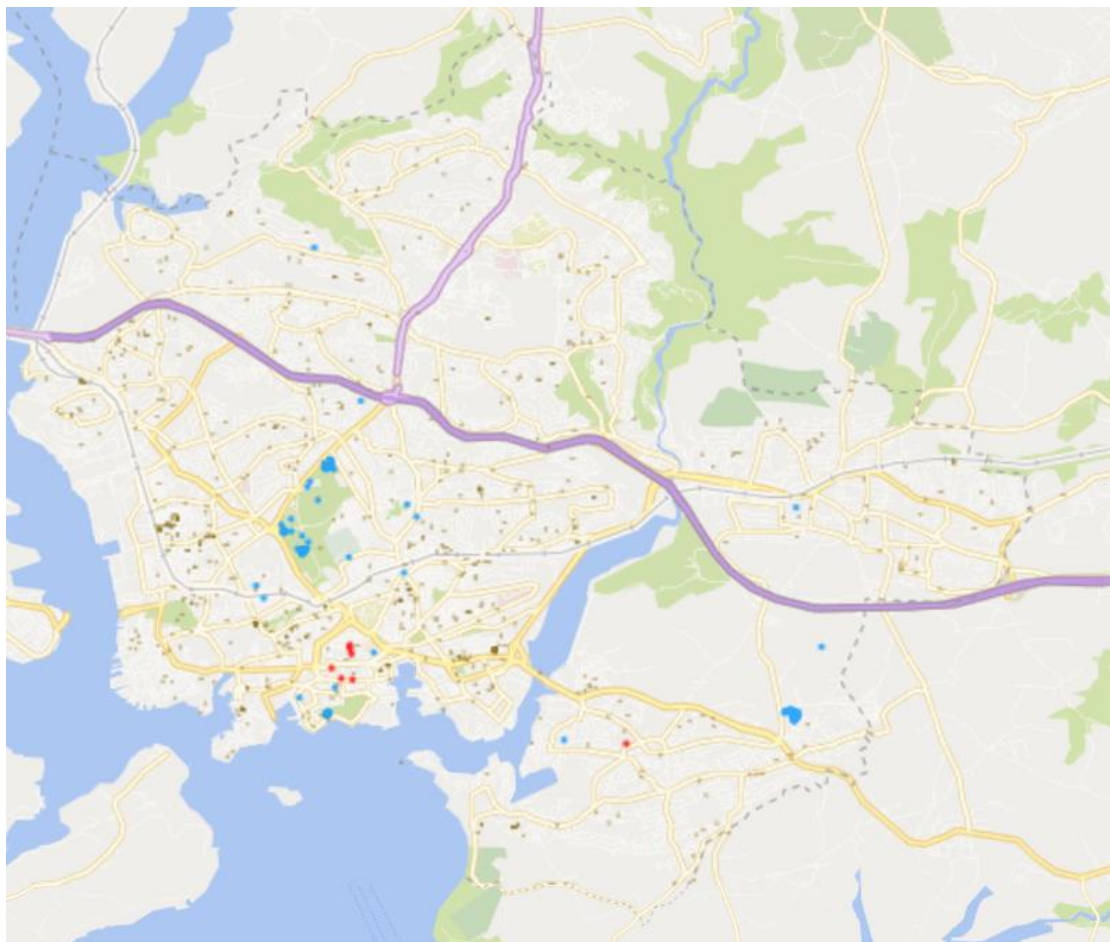

This page is intentionally left blank

Appendix 5**Public Spaces Protection Order – Control of Dogs Consultation 2020****Results of Consultation**

1454 responses were received

Part A – Dog fouling

Dog owners/walkers are currently required to pick up dog faeces after their dog fouls. This applies to all open land to which the public are entitled and permitted to have access, with or without payment. Forestry commission land is excluded. Bins are provided in certain locations, but if there is no bin, you must take it home with you. Assistance dogs are exempt from this requirement.

Question	Response	Summary of Comments
<p>It is intended to keep the existing controls relating to dog fouling:</p> <ul style="list-style-type: none"> You must pick up your dog's faeces <p>I. Do you agree that dog owners/walkers should pick up their dog's poo?</p>	<p>Yes – 99.8% No – 0.2%</p>	N/A
The proposed PSPO includes a new requirement in relation to having the means to pick up dog faeces:	<p>Yes – 95.1% No – 4.9%</p>	<p>No: Dog walker may have forgotten to take bags Dog walker may have already used bags</p>

<ul style="list-style-type: none">You must always have something to pick up the faeces with, e.g. bags, and produce evidence of this if asked by an Authorised Officer <p>2. Do you agree that dog owners/walkers should carry something to pick up their dog’s poo, e.g. poo bags? If no – please give your reasons</p>		Don’t agree with being asked to produce bags if asked
--	--	---

Part B – Dogs exclusion

This is a control measure to protect the health and safety of people using some of our specific facilities in Plymouth, so dogs are currently excluded from them.

Question	Response	Summary of Comments
<p>It is intended to keep the existing controls relating to these facilities:</p> <ul style="list-style-type: none">You are not allowed to let your dog enter any children’s play area, bowling green, croquet lawn, skate park, putting green, crazy golf or school grounds that are totally enclosed and have exclusion signs at the entrances.	<p>Yes – 86.9% No – 13.1%</p>	N/A

3. Do you agree that dogs should be excluded from these areas?		
Dogs are currently excluded from Efford Cemetery and Weston Mill Cemetery. It is intended to keep this restriction: <ul style="list-style-type: none">You are not allowed to let your dog enter Efford Cemetery and Weston Mill Cemetery 4. Do you agree that dogs should be excluded from Efford and Weston Mill Cemeteries?	Yes – 63.5% No – 36.5%	N/A

Part C – Dogs on leads

This is a control measure to assist with tackling dog fouling in specific areas. These areas are small, family orientated or ornamental parks, or are for sporting activities:

CI Parks

Question	Response	Summary of Comments
In the following parks, dogs are currently required to be on a lead. It is intended that this restriction remains in the proposed PSPO. <ul style="list-style-type: none">Pounds ParkWest Hoe Park	Yes – 69.8% No – 30.2%	No: Well-controlled dog should not be on a lead Dogs need to exercise off a lead Dogs should be under control but not on a lead

<ul style="list-style-type: none"> • Moor View Park • Stoke Damerell Park • Houndiscombe Park • Thorn Park <p>5. Do you agree that dogs should be on a lead within these parks? If no – please give your reasons</p>		<p>Dog fouling and uncontrolled dogs are more important</p> <p>Parks are for dogs as well as people</p> <p>There are too many areas with restrictions</p> <p>People may not have transport to take dogs elsewhere</p>
--	--	---

Central Park:

In the area of Central Park (shown in map), dogs are required to be on a lead. This specific area and the surrounding area of Central Park have recently undergone significant development and improvement in line with our Council strategies relating to the use of open spaces, including Plymouth's Green Spaces Strategy.

Therefore, the dog controls in Central Park have been reviewed. It is proposed that the area where dogs are required to be on a lead is extended. Your views are being sought on 2 options:

Question	Response	Summary of Comments
<p>Option 1 – the proposal is for dogs to be required to be kept on a lead in the car park and the fields between the current restricted area and the Life Centre known as the Central Area (Area A)</p> <p>6. Do you agreed that dogs should be kept on a lead in Area A? Please give your reasons</p>	<p>Yes – 55.3%</p> <p>No – 44.7%</p>	<p>Yes:</p> <p>Busy area in the car park and outside the Life Centre</p> <p>High footfall</p> <p>Used by families with children</p> <p>Used by sports people, runners, cyclists</p> <p>Danger of traffic</p>

		<p>Dog owners don't always have control of their dogs</p> <p>Safety reasons</p> <p>Some dogs are nervous</p> <p>Reduce fouling</p> <p>No:</p> <p>Well-controlled dogs do not need to be on a lead</p> <p>Dogs need exercise off a lead</p> <p>Agree to for dogs on leads in the car park and outside the Life Centre, but not the 2 fields</p> <p>No need to change things</p> <p>Increases the density of dogs in other areas</p> <p>Too many restrictions all ready</p> <p>Cyclists speeding and children running around</p>
<p>Option 2 – the proposal is for dogs to be required to be kept on a lead to include the fields to the south of the current restricted area known as the Southern Slopes Area (Area B)</p> <p>7. Do you agree that dogs should be kept on a lead in Area B? Please give your reasons</p>	<p>Yes – 23.8%</p> <p>No – 76.2%</p>	<p>Yes:</p> <p>Dogs are a potential nuisance and can be annoying</p> <p>Families should be able to relax and enjoy the park</p> <p>Not all dogs are under control</p> <p>For safety of people, especially children</p> <p>Some people are scared of dogs</p> <p>These fields are used for sport</p> <p>Prevent fouling</p> <p>No:</p> <p>This area is popular with dog walkers</p> <p>Responsible owners keep their dogs under control</p>

		Families need areas for dogs and children Not enough space for dogs to run freely It's a large area that doesn't need restrictions Current restrictions are adequate Unreasonable Some people can't walk to other parts of the park, e.g. those in wheelchairs, with pushchairs Those that don't pick up are the minority Don't punish all dog walkers Leaves too little space with no restrictions Too large an area Disadvantages those without a car Dog owners support the local café Dog owners use the park in all weathers throughout the year Sports facilities are hardly used
--	--	--

C2 Sports Facilities

This section relates to all sports facilities in Plymouth that are owned or managed by the Council.

The requirement for dogs to be on a lead on sports pitches is a control measure to assist with tackling dog fouling in areas which are specifically designated for a sporting activity. These areas are used for formal matches within a league structure and by people making use of

these sporting facilities informally at other times. Therefore, it is essential that these areas are clear from dog fouling to minimise the risk to health at all times.

Dogs are currently required to be on a lead on a marked sports pitch. Your views are being sought on the restrictions being in place all year round and on all sports facilities, including pitches and athletics tracks. You are also asked whether you think the restrictions should be changed to require dogs to be excluded from sports pitches.

Question	Response	Summary of Comments
<p>8. Do you think this restriction should be in place all year round on all sports facilities? Please give your reasons</p>	<p>Yes – 41.7% No – 58.3%</p>	<p>Yes: Sport pitches should be clean and safe Dogs can be dangerous and can interfere with the game, chase the balls Plenty of other areas to exercise dogs Keeps sport and dogs separate To reduce fouling Health and safety and hygiene reasons</p> <p>No: Pitches not in use all year, hardly used Restrictions should be in the sports season Too restrictive Shouldn't be a blanket restriction Should be available to dog walkers when not used for sport Restricting the area for dog walking Responsible dog owners pick up poo</p>

<p>9. Do you think dogs should be on a lead or excluded from sports facilities? Please give your reasons</p>	<p>On a lead – 47.5% Excluded – 20.2% Neither – 32.3%</p>	<p>On a lead: When sports facilities are being used Owners can deal with fouling Families watch sports and take dogs Keep them under control during matches Dog fouling will be picked up</p> <p>Excluded: Keep area clean, reduce fouling So they don't disrupt the game Areas are for sport Health and safety Other areas are available</p> <p>Neither: Majority of dog owners are responsible Parks are used by everyone Other mess is left by people, nappies, litter, etc.</p>
--	--	---

C3 New Crematorium Site

Question	Response	Summary of Comments
<p>Plymouth City Council is developing a new crematorium at Haye Road, Plymouth. It is proposed that dogs should be required to be kept on a lead on this site when it is open to the public.</p> <p>10. Do you think that dogs should be kept on a lead on the new crematorium site in Plymouth? Please give your reasons</p>	<p>Yes – 88.5% No – 11.5%</p>	<p>Yes: Out of respect Health and safety reasons To stop fouling Keep area clean Appropriate, reasonable restriction</p> <p>No: Dogs should be under control Dog fouling is the issue</p>

Part D – Dogs on leads by direction

Under the current PSPO, if your dog's behaviour is causing a nuisance, annoyance or disturbance to any person, animal or bird and it needs to be on a lead to prevent this, you may be asked to put your dog on a lead.

The Council want to clarify when dog owners or walkers must put their dog on a lead. The proposed PSPO will require a dog owner or dog walker to put their dog on a lead in order to prevent a detrimental effect on the quality of life of those in the locality and minimise the risk to the health and safety of other people or animals who are using the parks and open spaces. For example, you may be asked to put your dog on a lead to control its behaviour or to ensure it is under control during specific events being held in that area or to ensure social distancing, if required.

Question	Response	Summary of Comments
<ul style="list-style-type: none"> You will be required to put your dog on a lead by an Authorised Officer if such restraint is reasonably necessary to prevent a nuisance or if its behaviour is likely to cause alarm, distress or disturbance to any other person or animal or bird <p>11. Do you agree that, in these circumstance, a dog should be put on a lead if requested to do so by an Authorised Officer in such circumstances?</p> <p>If no - please give your reasons</p>	Yes – 87.1% No – 12.9%	No: Need clear reasons, currently not clear Vague definition of nuisance or distress Responsible owners will have their dog on a lead Should be a Police power Dogs should be under control

Part E – Additional questions

Question	Response	Summary of Comments
<p>12. Do you have any alternative or additional proposals on dog control?</p> <p>If yes – please give reasons</p>	Yes – 35% No – 65%	Yes: Concentrate on fouling Educate not fine Clear signage Clear markings More dog poo bins Dogs only areas

		Concentrate on litter, cyclists, anti-social behaviour, fly tipping, fireworks, motorbikes Checks on owners, licensing Dog behaviour test Provide dog poo bag stations Harsher penalty for fouling, increase the fine Enforce what exits Promote reporting with evidence Publicise the number of people fined Licensing could find enforcement Control the number of people meeting with their dogs Dogs on leads in town, roads Family area should be dog free Deal with individuals not everyone Dog owners should have insurance Restrictions in parks could be seasonal Restrictions could be timed Enforcement by plain clothed officers Increase enforcement for fouling in all areas, not just parks Fence off the whole family area Increase patrols, especially early mornings and evenings
13. Are there any additional areas that you feel should be added or removed from the proposed PSPO? If yes – please give reasons	Yes – 23.9% No – 76.1%	Yes: Only 346 answered yes, most were very general comments relating to issues mentioned in previous questions.

		<p>Very few (4 or less) suggested including restrictions in additional specific area:</p> <p>The Hoe Devonport Park Mountwise Tothill Park Frogmore Field City centre Victoria Park Freedom fields Park Collings Park Astor Park Ham Woods King George V Beeches Devils Point Jennycliffe</p> <p>Very few (2 or less) suggested removing restrictions from:</p> <p>Pounds Park King George V</p>
<p>I4. Are there any adverse impacts to the proposals that you wish to highlight? If yes – please give reasons</p>	<p>Yes – 39.6% No – 60.4%</p>	<p>Impact on environment – increased use of cars to take dogs elsewhere will increase traffic, increase in litter and vandalism, increased use of nature reserves</p>

		Impact on economy – dog walkers use local cafes, dog walkers and families may not support new facilitates Impact on mental health – people will exercise less, impact on disabled and elderly Impact on health of dog – lack of exercise, increase in noise if left at home Impact on park community – more conflict between users, e.g. dog walkers and cyclists £100 fine is excessive Discrimination against dog owners
15. Do you own or walk dogs?	Yes – 81.3% No – 18.7%	N/A
16. Do you walk dogs in Plymouth?	Yes – 80.7% No – 19.3%	N/A

This page is intentionally left blank

EXECUTIVE DECISION

made by a Cabinet Member



REPORT OF ACTION TAKEN UNDER DELEGATED AUTHORITY BY AN INDIVIDUAL CABINET MEMBER

Executive Decision Reference Number – SP107 20/21

Decision	
1	<p>Title of decision:</p> <p>THE CITY OF PLYMOUTH (TRAFFIC REGULATION ORDERS) (AMENDMENT ORDER NO. 2020.2137238 TAXI SCHEME) ORDER</p> <p>&</p> <p>THE CITY OF PLYMOUTH (TRAFFIC REGULATION ORDERS) (TAXI RANKS) (AMENDMENT ORDER NO. 2020.2137238 TAXI SCHEME) ORDER</p>
2	<p>Decision maker (Cabinet member name and portfolio title): Councillor Mark Coker, Cabinet Member for Strategic Planning and Infrastructure</p>
3	<p>Report author and contact details: Amy Neale, Senior Traffic Management Technician, email: amy.neale@plymouth.gov.uk Tel: 01752 307472</p>
4	<p>Decision to be taken:</p> <p>To implement amendments to The City of Plymouth (Traffic Regulation and Street Parking Places) (Consolidation) Order 2004 and The City of Plymouth (Traffic Regulation Orders) (Taxi Ranks) 2014</p> <p>The effect of the order shall be to Add/Amend:</p> <p>No Waiting At Any Time & Pay And Display on lengths of the following road: Whimble Street</p> <p>No Stopping except Taxis at Any Time on lengths of the following roads: Cornwall Street, Eastlake Street, St Andrews Cross & Whimble Street</p> <p>As set out in the briefing report.</p>
5	<p>Reasons for decision:</p> <p>Taxi Rank construction on Whimble Street & Eastlake Street and associated TO amendments are required to be authorised and live to allow following project construction works to progress.</p> <p>In line with the Road Traffic Regulation Act 1984, SI, this request, under this section, is expedient to make it for improving the amenities of the area through which the roads run.</p> <p>Conversion of areas to new taxi rank use to allow a regeneration of New George Street East and Old Town Street.</p>

6	Alternative options considered and rejected: <p>Option 1: Do nothing</p> <p>The new taxi ranks are part of a wider scheme to regenerate Old Town Street and New George Street. If the new taxi ranks were not created then the existing rank in Old Town Street would need to remain in place. This would significantly undermine to objectives of the scheme and jeopardise the substantial private sector investment that this scheme unlocks.</p> <p>Option 2: St Andrews Cross North</p> <p>An option to locate the taxi rank (or part of the rank) on the north side of St Andrews Cross roundabout was considered early in the scheme and on the recommendation of Plymouth taxi trade representatives. This design was assessed as part of the Stage 1 Road Safety Audit (RSA) that found significant safety risks due to the angle at which taxis would re-enter the roundabout from the rank. This option was rejected early in the design process due to these safety concerns.</p>									
7	Financial implications: <p>The Traffic Regulation Order (TRO) and associated works is being funded via Approved Capital Funding.</p>									
8	Is the decision a Key Decision? (please contact Democratic Support for further advice)	Yes	No	Per the Constitution, a key decision is one which: <table border="1"> <tr> <td data-bbox="853 969 965 1137">x</td> <td data-bbox="965 969 1497 1137">in the case of capital projects and contract awards, results in a new commitment to spend and/or save in excess of £3million in total</td> </tr> <tr> <td data-bbox="853 1137 965 1283">x</td> <td data-bbox="965 1137 1497 1283">in the case of revenue projects when the decision involves entering into new commitments and/or making new savings in excess of £1million</td> </tr> <tr> <td data-bbox="853 1283 965 1435">x</td> <td data-bbox="965 1283 1497 1435">is significant in terms of its effect on communities living or working in an area comprising two or more wards in the area of the local authority.</td> </tr> </table>	x	in the case of capital projects and contract awards, results in a new commitment to spend and/or save in excess of £3million in total	x	in the case of revenue projects when the decision involves entering into new commitments and/or making new savings in excess of £1million	x	is significant in terms of its effect on communities living or working in an area comprising two or more wards in the area of the local authority.
x	in the case of capital projects and contract awards, results in a new commitment to spend and/or save in excess of £3million in total									
x	in the case of revenue projects when the decision involves entering into new commitments and/or making new savings in excess of £1million									
x	is significant in terms of its effect on communities living or working in an area comprising two or more wards in the area of the local authority.									
9	Please specify how this decision is linked to the Council's corporate plan/Plymouth Plan and/or the policy framework and/or the revenue/capital budget:	The Local Transport Plan (LTP) details the transport strategies and policies that the City Council has adopted and will be key in helping the city meet its Corporate Plan priorities, and growth agenda.								
10	Please specify any direct environmental implications of the decision (carbon impact)	n/a								
Urgent decisions										
11	Is the decision urgent and to be	Yes		(If yes, please contact Democratic						

	implemented immediately in the interests of the Council or the public?			Support (democraticsupport@plymouth.gov.uk) for advice)
		No	x	(If no, go to section 13a)
12a	Reason for urgency:			
12b	Scrutiny Chair Signature:		Date	
	Scrutiny Committee name:			
	Print Name:			
Consultation				
13a	Are any other Cabinet members' portfolios affected by the decision?	Yes		
		No	x	(If no go to section 14)
13b	Which other Cabinet member's portfolio is affected by the decision?			
13c	Date Cabinet member consulted	Councillor Mark Coker – 07/07/2020		
14	Has any Cabinet member declared a conflict of interest in relation to the decision?	Yes		If yes, please discuss with the Monitoring Officer
		No	x	
15	Which Corporate Management Team member has been consulted?	Name	Anthony Payne	
		Job title	Strategic Director for Place	
		Date consulted	13/08/2020	
Sign-off				
16	Sign off codes from the relevant departments consulted:	Democratic Support (mandatory)	DS27 20/21	
		Finance (mandatory)	pl.20.21.65.	
		Legal (mandatory)	LS/35197/JP/190820	

		Human Resources (if applicable)						
		Corporate property (if applicable)						
		Procurement (if applicable)						
Appendices								
17	Ref.	Title of appendix						
	A	Briefing report						
	B	Equalities Impact Assessment						
Confidential/exempt information								
18a	Do you need to include any confidential/exempt information?	Yes						
		No	x					
		If yes, prepare a second, confidential ('Part II') briefing report and indicate why it is not for publication by virtue of Part I of Schedule 12A of the Local Government Act 1972 by ticking the relevant box in 18b below. (Keep as much information as possible in the briefing report that will be in the public domain)						
		Exemption Paragraph Number						
		1	2	3	4	5	6	7
18b	Confidential/exempt briefing report title:							
Background Papers								
19	Please list all unpublished, background papers relevant to the decision in the table below. Background papers are <u>unpublished</u> works, relied on to a material extent in preparing the report, which disclose facts or matters on which the report or an important part of the work is based. If some/all of the information is confidential, you must indicate why it is not for publication by virtue of Part I of Schedule 12A of the Local Government Act 1972 by ticking the relevant box.							
Title of background paper(s)		Exemption Paragraph Number						
		1	2	3	4	5	6	7

Cabinet Member Signature							
20	I agree the decision and confirm that it is not contrary to the Council's policy and budget framework, Corporate Plan or Budget. In taking this decision I have given due regard to the Council's duty to promote equality of opportunity, eliminate unlawful discrimination and promote good relations between people who share protected characteristics under the Equalities Act and those who do not. For further details please see the EIA attached.						
Signature				Date of decision	16/09/2020		
Print Name	Mark Coker						

This page is intentionally left blank



TAXI SCHEME

I. INTRODUCTION

This report seeks delegated authority to implement amendments to The City of Plymouth (Traffic Regulation and Street Parking Places) (Consolidation) Order 2004 (as amended) & The City of Plymouth (Traffic Regulation Orders) (Taxi Ranks) 2014” (as amended) in association with the Taxi Scheme.

TRAFFIC REGULATION ORDERS REQUIRED

2.1 The elements that need a Traffic Regulation Order are as follows:

To Add;

No Waiting at Any Time

- (i) Whimble Street, the north side for its entirety including the eastern closed end
- (ii) Whimble Street (side road), the east side from its junction with Wimble Street (main road) for a distance of 4 metres in a northerly direction
- (iii) Whimble Street (side road), the east side from a point 22 metres north of its junction with Whimble Street (main road) to its junction with St Andrews Cross
- (iv) Whimble Street (side road), the west side for its entirety

Pay And Display At Any Time 8am-5.59pm Maximum Stay 2 hours No Return Within 1 Hour

- (i) Whimble Street (side road), the east side from a point 4 metres north of its junction with Whimble Street (main road) for a distance of 18 metres in a northerly direction

No Stopping except Taxis at Any Time

- (i) Cornwall Street & Eastlake Street, the south-east side from a point 104 metres south of its junction with Cobourg Street for a distance of 33 metres in a south westerly direction
- (ii) Eastlake Street, the east side from a point 74 metres south of its junction with Cobourg Street for a distance of 21 metres in a southerly direction
- (iii) St Andrews Cross, the south-west side from a point 14 metres south east of its junction with Royal Parade for a distance of 16 metres in a south easterly direction
- (iv) Whimble Street, the n-e & n-w side from its junction with St Andrews Street Car Park for a distance of 28 metres in a south easterly and north easterly direction

Revocations:

No Waiting at Any Time

- (i) Whimble Street, the north side, from the junction with St Andrew Street (North) for the entire length

2. STATUTORY CONSULTATION

Proposals

The proposals for The Taxi Scheme were advertised on street, in the Herald and on the Plymouth City Council website on 22nd July 2020. Details were sent to the Councillors representing the affected ward and statutory consultees on 15th July 2020.

There have been no representations received relating to the Traffic Regulation Order proposals.

4. RECOMMENDATION

It is recommended to proceed with original proposals as advertised and make the Traffic Regulation Order.

5. LEGAL CONSIDERATIONS

The lawful implications and consequences of the proposal have been considered and taken into account in the preparation of this report.

When considering whether to make a traffic order it is the Council's responsibility to ensure that all relevant legislation is complied with. This includes Section 122 of the Road Traffic Regulation Act 1984 (as amended) that sets out that it is the duty of a local authority, so far as practicable subject to certain matters, to secure the expeditious, convenient and safe movement of vehicular and other traffic (including pedestrians) and the provision of suitable and adequate parking facilities on and off the highway. It is considered that the proposals comply with Section 122 of the Act as they practically secure the safe and expeditious movement of traffic in and around Plymouth and provide for suitable and adequate associated parking facilities.

EQUALITY IMPACT ASSESSMENT

Taxi Rank Orders



STAGE 1: WHAT IS BEING ASSESSED AND BY WHOM?

What is being assessed - including a brief description of aims and objectives?	<p>As part of the regeneration of Old Town Street and New George Street two new taxi ranks are being constructed to replace the existing rank at Old Town Street. In order to do this a Traffic Regulation Order is required which will:</p> <p>Implement amendments to The City of Plymouth (Traffic Regulation and Street Parking Places) (Consolidation) Order 2004 and The City of Plymouth (Traffic Regulation Orders) (Taxi Ranks) 2014</p> <p>The effect of the order shall be to Add/Amend:</p> <p>No Waiting At Any Time & Pay And Display on lengths of the following road: Whimble Street</p> <p>No Stopping except Taxis at Any Time on lengths of the following roads: Cornwall Street, Eastlake Street, St Andrews Cross & Whimble Street</p>
Author	Tom Lowry
Department and service	Strategic Planning and Infrastructure
Date of assessment	12/08/2020

STAGE 2: EVIDENCE AND IMPACT

Protected characteristics (Equality Act)	Evidence and information (eg data and feedback)	Any adverse impact See guidance on how to make judgement	Actions	Timescale and who is responsible

Age	<ul style="list-style-type: none"> ▪ The average age in Plymouth (39.0 years) is about the same as the rest of England (39.3 years), but less than the South West (41.6yrs). • Of the 16 SW authorities we have the third lowest percentage of older people (75), and the fifth highest percentage of children and young people (under 18). • Children and young people (CYP) under 18 account for 19.8 per cent of our population, within this 88.8 per cent are under 16. • In December 2016 it was estimated that 5.5% of young people in our city aged between 16 and 18 were not in Education, Employment or Training (NEET) young people. Of those 457 young people who are NEET, approximately 25 % are known to have specific vulnerabilities. • The proportion of the working age population (16-64) is higher (66.1 per cent) than regionally (62.8 per 	<p>No adverse impact is anticipated.</p> <p>The proposed taxi rank will cater for people of all ages and will utilise standard city centre directional signage and taxi rank regulatory signage to ensure it is easy to find and understand. This is part of the proposed scheme.</p>	Na	Na
-----	--	---	----	----

	<p>cent) and nationally (64.7 per cent).</p> <ul style="list-style-type: none"> Plymouth has the sixth highest percentage of working age people in the South West. 			
Disability	<ul style="list-style-type: none"> A total of 31,164 people (from 28.5 per cent of households) declared themselves as having a long-term health problem or disability (national figure 25.7 per cent of households), compared with the total number of people with disabilities in UK (11,600,000). 10 per cent of our population have their day-to-day activities limited a lot by a long-term health problem or disability. 1,297 adults registered with a GP in Plymouth have some form of learning disability (2013/14). 	<p>No adverse impact is anticipated.</p> <p>The new taxi ranks have been designed to meet current design guidance to ensure suitable access and egress for all. During the design process a range of stakeholders were consulted including representatives of the Plymouth taxi trade and Plymouth Accessibility and Disability Network (PADAN). Both of these groups provided valuable feedback that informed the final design.</p>	Na	Na

	<ul style="list-style-type: none">• Plymouth schools report that of every 1,000 children 17.5 have a learning difficulty.• There are 27166 adults with a disability in work.• There are 23,407 carers aged between 18 and 64 in Plymouth known to our services.• There are 17,937 state pension age people with disability.• There are 3,142 children with disability.• National figures in March 2014, record that 143,400 people were registered as blind, a decrease of 4,400 (three per cent) from March 2011.• Similarly 147,700 people were registered as partially sighted, a decrease of 3,300 (two per cent) from March 2011. <p>Our Translate</p>			
--	---	--	--	--

	<p>Plymouth services recorded that BSL is amongst our most requested languages.</p> <ul style="list-style-type: none"> Over 13,000 people in our City are currently dependent on ESA. 			
Faith/religion or belief	<ul style="list-style-type: none"> 84,326 (32.9 per cent) of the Plymouth population stated they had no religion. Those with a Hindu, Buddhist, Jewish or Sikh religion combined totalled less than 1 per cent. Christianity: 148,917 people (58.1 per cent), decreased from 73.6 per cent since 2001. Islam: 2,078 people (0.8 per cent), doubled from 0.4 per cent since 2001. Buddhism: 881 people (0.3 per cent), increased from 0.2 per cent since 2001. Hinduism: 567 people (0.2 per cent) 	The proposals will have no impact on any individual based on faith / religion or belief.	None	N/A

	<p>described their religion as Hindu, increased from 0.1 per cent since 2001.</p> <ul style="list-style-type: none"> • Judaism: 168 people (0.1 per cent), decreased from 181 people since 2001. • Sikhism: 89 people (less than 0.1 per cent), increased from 56 people since 2001. • 0.5 per cent of the population had a current religion that was not Christianity, Islam, Buddhism, Hinduism, Judaism or Sikh, such as Paganism or Spiritualism. 			
Gender - including marriage, pregnancy and maternity	<ul style="list-style-type: none"> • Overall 50.6 per cent of our population are women and 49.4 per cent are men: this reflects the national figure of 50.8 per cent women and 49.2 per cent men. • There were 3280 births in 2011. Birthrate trends have been on the increase since 2001, but since 2010 the number of 	The proposals will have no impact on any individual based on gender.	None	N/A

	<p>births has stabilised. Areas with highest numbers of births include Stonehouse (142), Whitleigh (137) and Devonport (137).</p> <ul style="list-style-type: none">• Of those aged 16 and over, 90,765 people (42.9 per cent) are married. 5,190 (2.5 per cent) are separated and still legally married or legally in a same-sex civil partnership.• In Plymouth in 2017 the mean difference between average hourly earnings (excluding overtime) of men and women as a proportion of average hourly earnings (excluding overtime) of men was 11.3%, the median difference was 14.9%. (ASHE)• Women employed by Plymouth City Council currently earn 97.4% of the average full time hourly wages of their male colleagues. (PCC Data)			
--	--	--	--	--

Gender reassignment	<ul style="list-style-type: none"> Recent surveys have put the prevalence of transgender people between 0.6 and 1% of population (some very recent reports have upped this to 2%). Over the last 8 years the prevalence of transgendered people in the UK has been increasing at an average rate of 20%+ per annum in adults and 50% for children. 	The proposals will have no impact on any individual based on gender reassignment	None	N/A
Race	<ul style="list-style-type: none"> 92.9% of people living in the city identify themselves as White British <p>7.1% identify themselves as Black and Minority Ethnic</p>	The proposals will have no impact on any individual based on Race	None	N/A
Sexual orientation - including civil partnership	<ul style="list-style-type: none"> There are no definitive data on sexual orientation at a local or national level. A recent estimate from the 2015 ONS Annual Population Survey (APS) suggests that 1.7 per cent of the UK population is LGB: if this figure was applied to Plymouth it would 	The proposals will have no impact on any individual based on Sexual Orientation	None	N/A

	mean that there are approximately 3,649 LGB people in the city.			
--	---	--	--	--

STAGE 3: ARE THERE ANY IMPLICATIONS FOR THE FOLLOWING? IF SO, PLEASE RECORD ACTIONS TO BE TAKEN

Local priorities	Implications	Timescale and who is responsible
Reduce the gap in average hourly pay between men and women by 2020.	There are no implications	
Increase the number of hate crime incidents reported and maintain good satisfaction rates in dealing with racist, disablist, homophobic, transphobic and faith, religion and belief incidents by 2020.	There are no implications	
Good relations between different communities (community cohesion)	These proposal are part of the wider regeneration of Old Town Street and New George Street to create a more pedestrian focused place for people of all communities to enjoy and that will create new opportunities for social interaction in the public realm.	
Human rights Please refer to guidance	There are no implications	

STAGE 4: PUBLICATION

Responsible Officer: Jonathan Bell – Head of Development Planning

Date: 13/08.2020

Strategic Director, Service Director, Head of Service or Group Manager

This page is intentionally left blank